

# GROUP 5 POWER TRAIN SYSTEM

Swing bearing

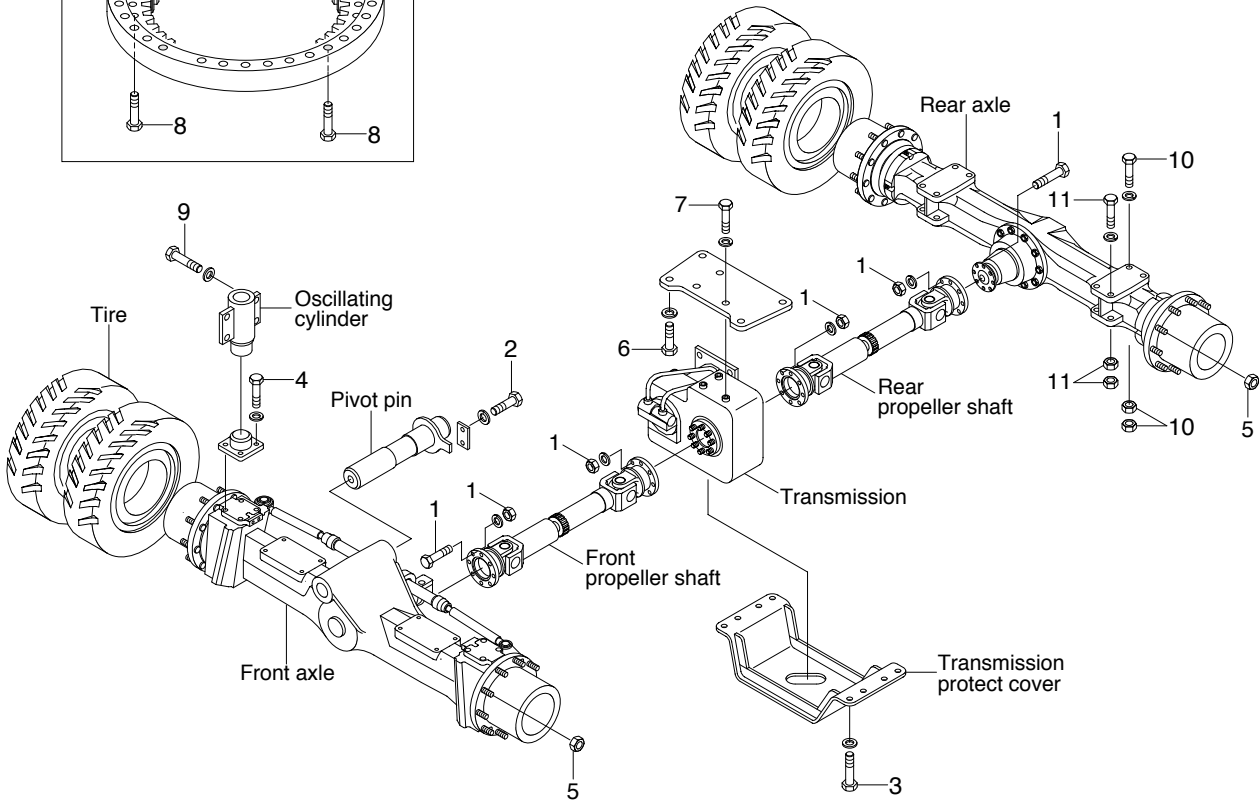
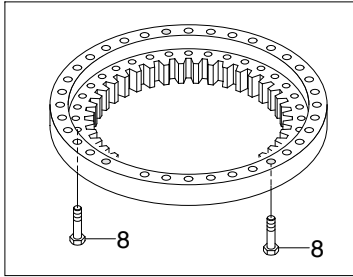

20W79CM08

· Tightening torque

Item	Size	kgf · m	lbf · ft
1	M10 × 1.0	5.9 ± 0.6	42.7 ± 4.3
2	M12 × 1.75	12.2 ± 1.3	88.2 ± 9.4
3	M12 × 1.75	12.8 ± 3.0	92.6 ± 21.7
4	M16 × 2.0	29.6 ± 3.2	214 ± 23.1
5	M20 × 1.5	50 ± 0.5	362 ± 3.6
6	M20 × 2.5	29.6 ± 3.2	214 ± 23.1

Item	Size	kgf · m	lbf · ft
7	M20 × 2.5	39 ± 4.2	282 ± 30.4
8	M20 × 2.5	57.8 ± 6.4	418 ± 46.3
9	M22 × 1.5	69.4 ± 10.4	502 ± 75.2
10	M24 × 2.0	100 ± 10.7	723 ± 77.4
11	M24 × 3.0	100 ± 10	723 ± 72.3
-	-	-	-

## COVER AND FOOT BOARD

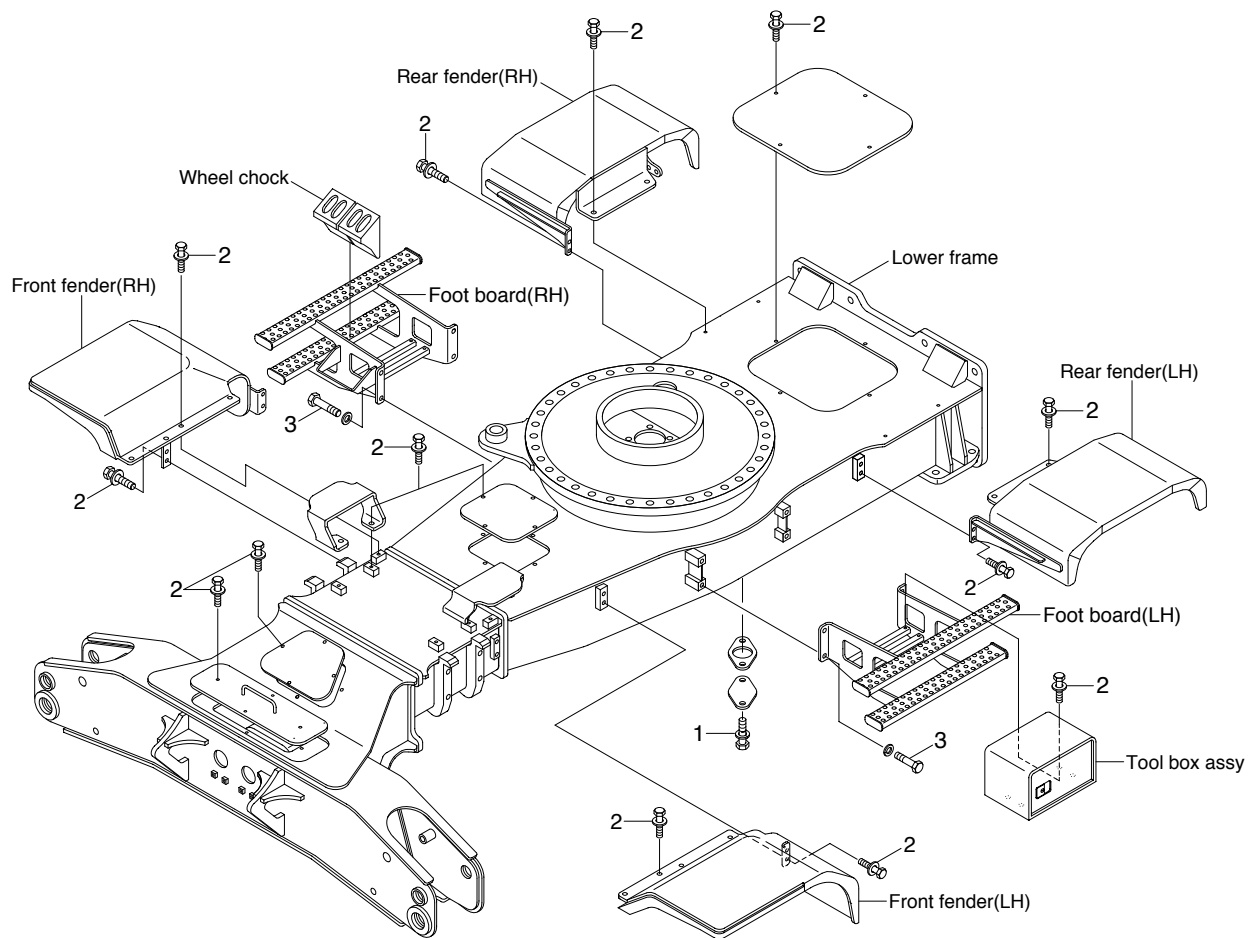

20W79CM09

### · Tightening torque

Item	Size	kgf · m	lbf · ft
1	M10 × 1.5	6.9 ± 1.4	49.9 ± 10.1
2	M12 × 1.75	12.8 ± 3.0	92.6 ± 21.7

Item	Size	kgf · m	lbf · ft
3	M20 × 2.5	57.9 ± 8.7	419 ± 62.9
-	-	-	-