

GROUP 3 WORK EQUIPMENT

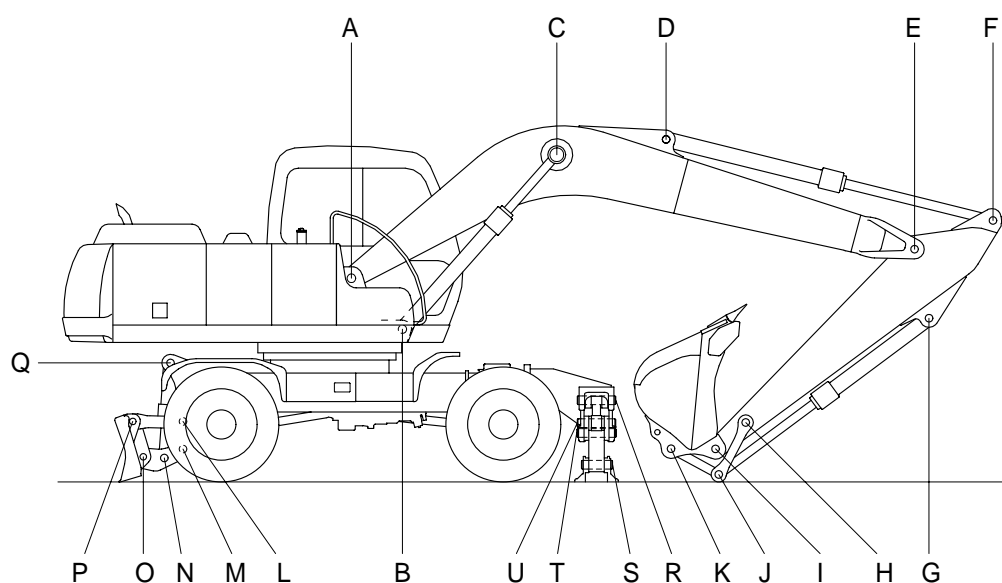

Unit : mm

Mark	Measuring point (Pin and Bushing)	Normal value	Pin		Bushing		Remedy & Remark
			Recomm. service limit	Limit of use	Recomm. service limit	Limit of use	
A	Boom Rear	75	74	73.5	75.5	76	Replace
B	Boom Cylinder Head	70	69	68.5	70.5	71	"
C	Boom Cylinder Rod	75	74	73.5	75.5	76	"
D	Arm Cylinder Head	70	69	68.5	70.5	71	"
E	Boom Front	75	74	73.5	75.5	76	"
F	Arm Cylinder Rod	70	69	68.5	70.5	71	"
G	Bucket Cylinder Head	70	69	68.5	70.5	71	"
H	Arm Link	70	69	68.5	70.5	71	"
I	Bucket and Arm Link	70	69	68.5	70.5	71	"
J	Bucket Cylinder Rod	70	69	68.5	70.5	71	"
K	Bucket Link	70	69	68.5	70.5	71	"
L	Dozer Link(B)	60	59	58.5	60.5	61	"
M	Dozer Link(A)	60	59	58.5	60.5	61	"
N	Dozer Cylinder Rod	70	69	68.5	70.5	71	"
O	Dozer Link(A)	60	59	58.5	60.5	61	"
P	Dozer Link(B)	60	59	58.5	60.5	61	"
Q	Dozer Cylinder Head	70	69	68.5	70.5	71	"
R	Outrigger Cylinder Head	75	74	73.5	75.5	76	"
S	Outrigger Foot	70	69	68.5	70.5	71	"
T	Outrigger Leg	70	69	68.5	70.5	71	"
U	Outrigger Cylinder Rod	75	74	73.5	75.5	76	"