

SECTION 4 ELECTRICAL SYSTEM



Group 1 Component Location -----	4-1
Group 2 Electrical Circuit -----	4-3
Group 3 Electrical Component Specification -----	4-22
Group 4 Connectors -----	4-31

SECTION 4 ELECTRICAL SYSTEM

GROUP 1 COMPONENT LOCATION

1. LOCATION 1

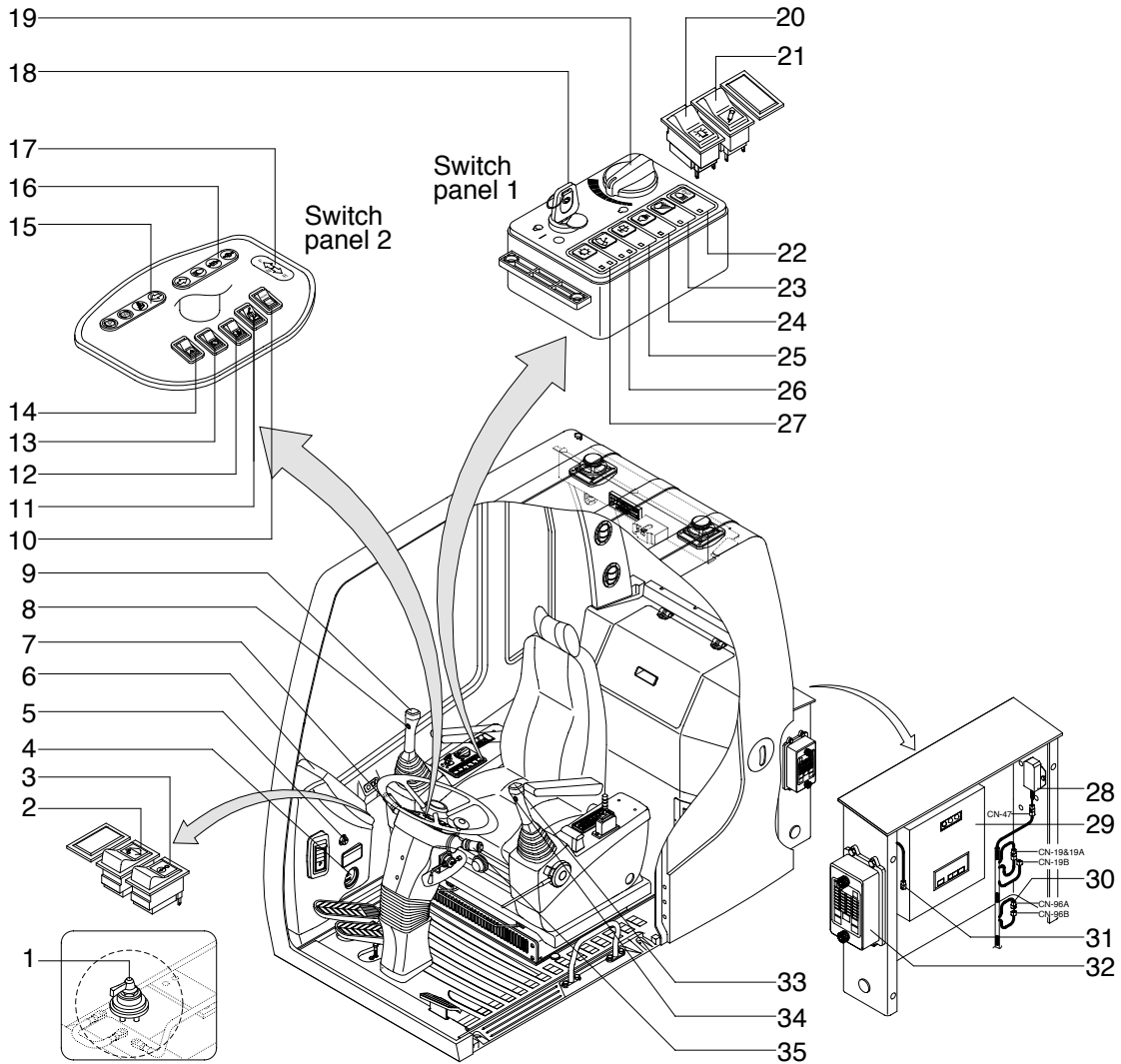

14W74EL01

- | | | |
|-----------------------------|-------------------------------|---|
| 1 Master switch | 13 Parking brake switch | 25 Washer switch |
| 2 Quick clamp switch | 14 Hazard switch | 26 Wiper switch |
| 3 Overload switch | 15 Travel warning indicator 1 | 27 Main light switch |
| 4 Service meter | 16 Travel warning indicator 2 | 28 Prolix resistor |
| 5 Ciger lighter | 17 Forward/Reverse pilot lamp | 29 CPU controller |
| 6 Cluster | 18 Start switch | 30 Emergency engine starting controller |
| 7 Multi function switch(RH) | 19 Accel dial | 31 RS232 serial connector |
| 8 Breaker operation switch | 20 Beacon switch | 32 Fuse box |
| 9 Horn switch | 21 Breaker selection switch | 33 One touch decel switch |
| 10 Work/Travel switch | 22 Cab light switch | 34 Power max switch |
| 11 Outrigger/Dozer switch | 23 Travel alarm switch | 35 Multi function switch(LH) |
| 12 Ram lock switch | 24 Preheat switch | |

2. LOCATION 2

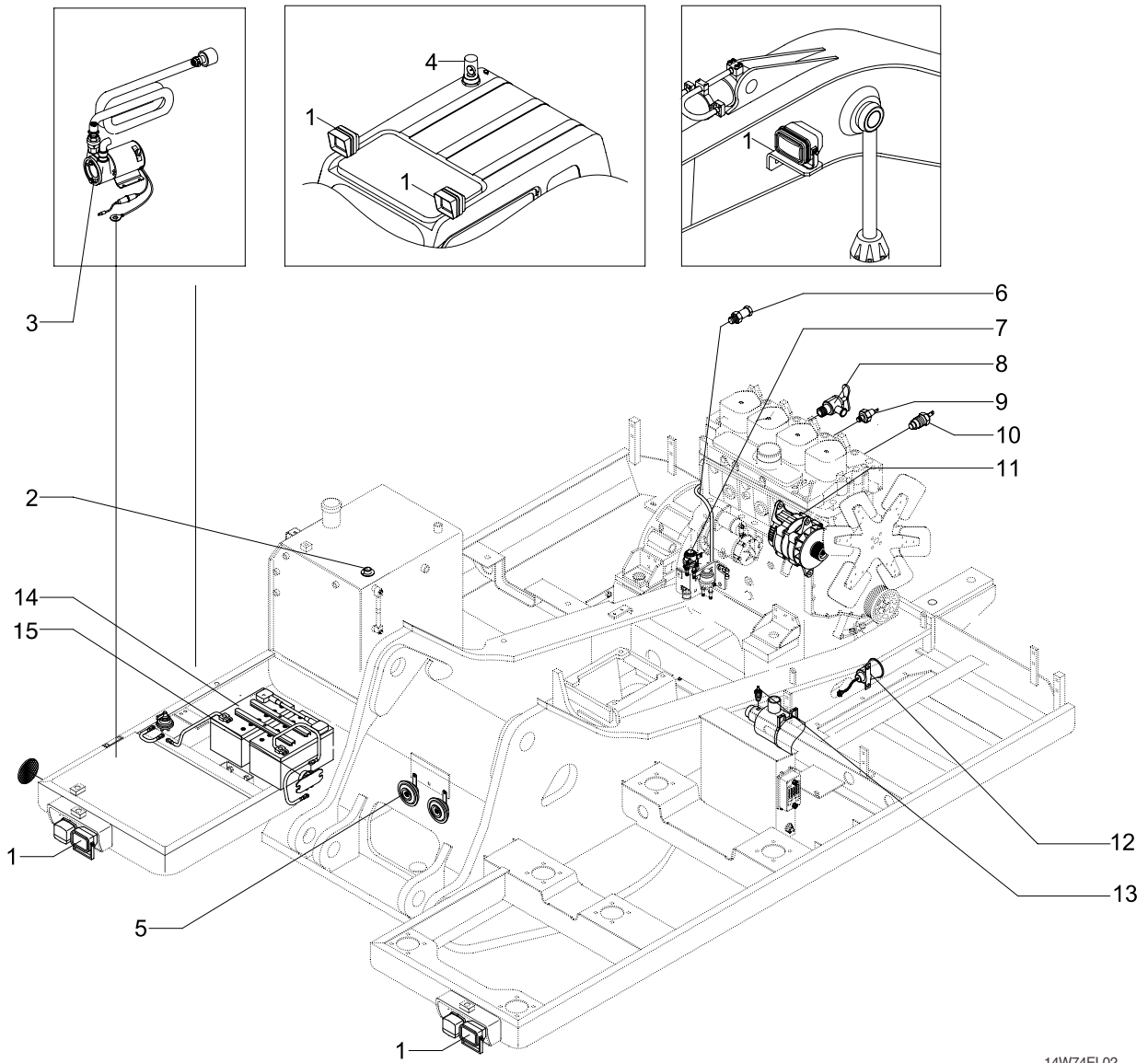

14W74EL02

- | | | | | | |
|---|------------------|----|----------------------------|----|---------------------|
| 1 | Lamp | 6 | Speed sensor | 11 | Alternator |
| 2 | Fuel sender | 7 | Start relay | 12 | Travel alarm buzzer |
| 3 | Fuel filler pump | 8 | Heater valve | 13 | Air cleaner switch |
| 4 | Beacon lamp | 9 | Engine oil pressure switch | 14 | Battery |
| 5 | Horn | 10 | Temp sender | 15 | Battery relay |