

4. CONTROL DEVICE

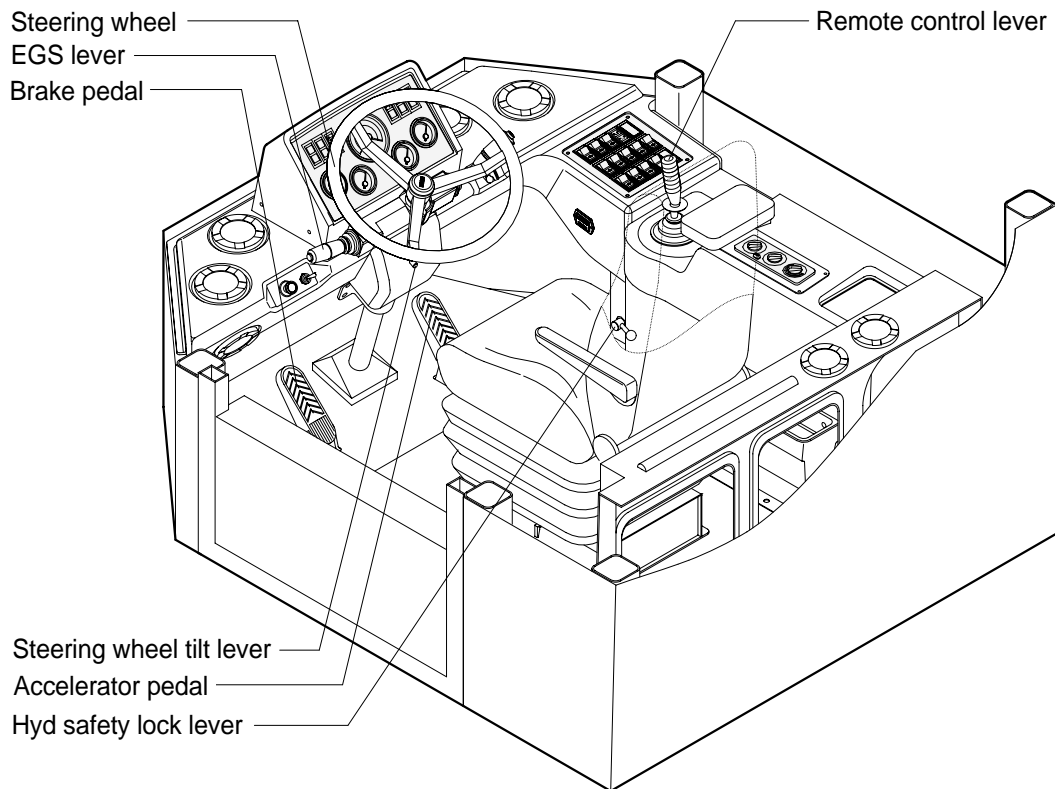

1) REMOTE CONTROL LEVER

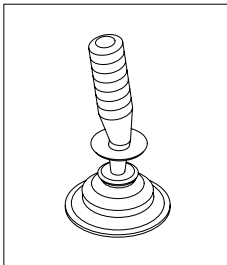

- (1) This joystick is used to control the boom and the bucket.
- (2) Refer to operation of working device in chapter 4 at page 4-7.

2) EGS LEVER

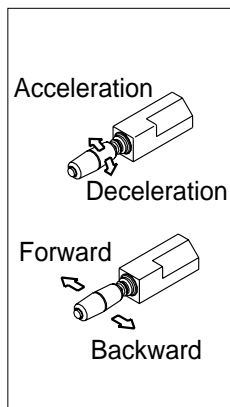

- (1) This lever is used for gear selection, forward 4 stages and reverse 4 stages.
- (2) If you push the EGS lever, the machine moves forward, but if pull the EGS lever, the machine moves backward.
- (3) If you turn the EGS lever forward, the machine increases the speed, but if you turn the EGS lever backward, the machine reduces the speed.

3) STEERING WHEEL

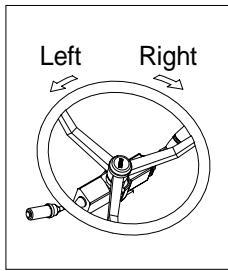

- (1) Two multi-motion cylinders in the center of the machine will operate the steering function.
- (2) If the steering wheel is turned to left, the machine will move to the left and turn it to the right, the machine will move to the right.

4) BRAKE PEDAL

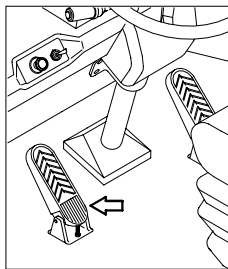

- (1) If the pedal is pushed, this will generate braking force and bring the machine to a stop.
- (2) If the power train operation is to be cut off, set the clutch cut off switch to ON and press the pedal.

▲ Even if the brake is applied while this switch is OFF, power train will not cut off.

Do not operate the machine with foot the brake pedal unnecessarily, or bring premature wear of brake disc.

5) ACCELERATOR PEDAL

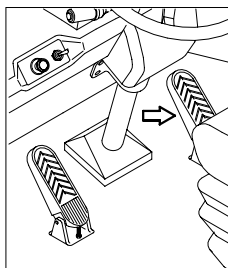

- (1) This pedal controls the engine speed. The engine speed will increase in proportion to the degree of force applied to this pedal.
- (2) Unless this pedal is pressed, the machine will run at low idling.

6) HYDRAULIC SAFETY LOCK LEVER

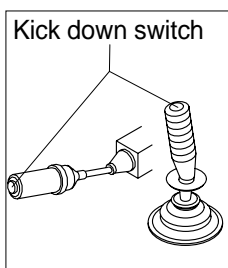

- (1) When the lever is turned to LOCK position, the hydraulic pilot line will be cut off, so the work equipment will not operate.

7) STEERING WHEEL TILT LEVER

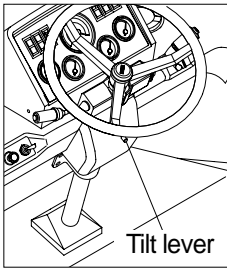

- (1) By pulling up the lever, the wheel is adjustable to fit the contours of the operator's body.
- (2) Forward/backward adjustment is available up to 10 degrees in 10 steps.