

5. MAINTENANCE CHART

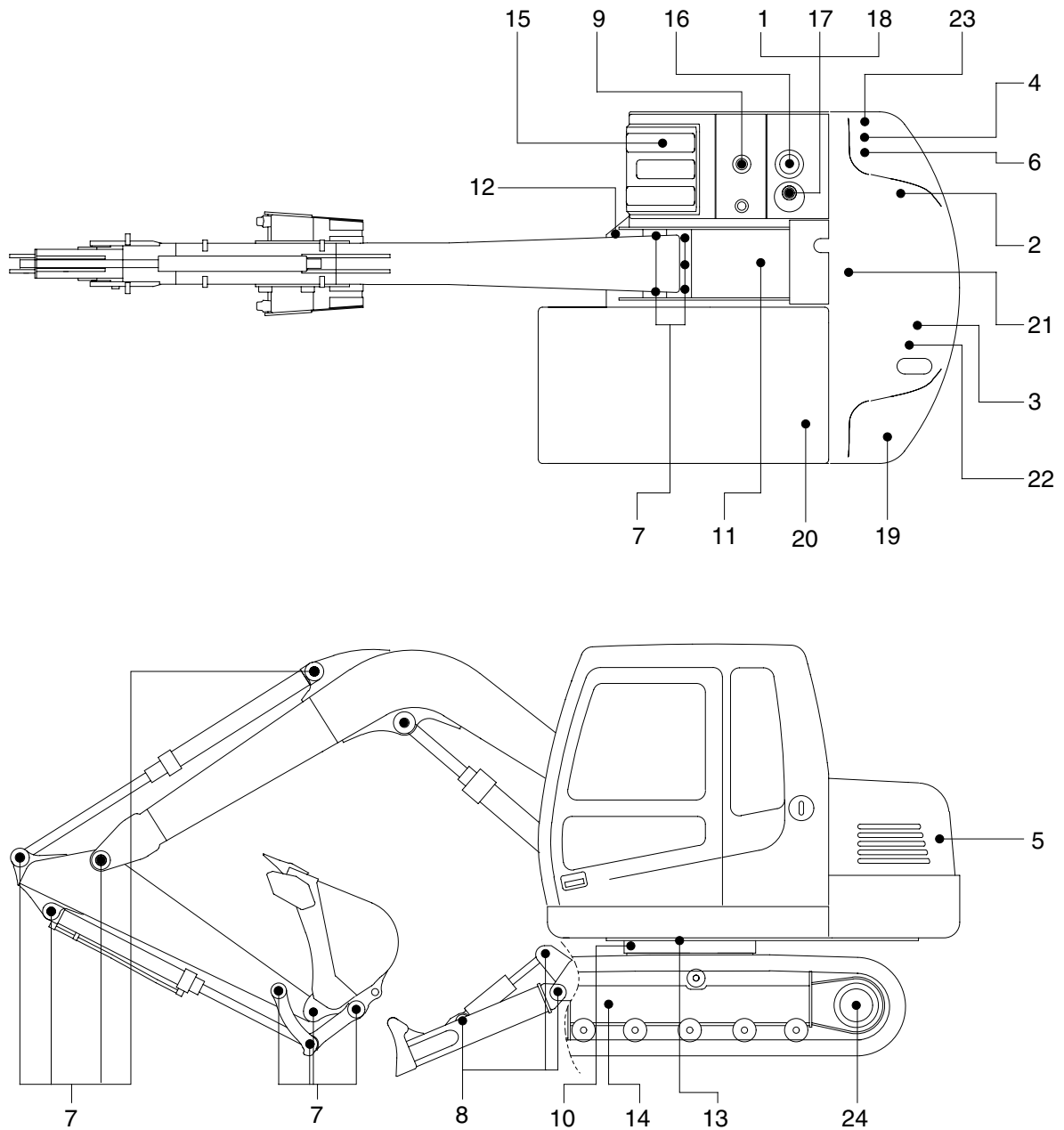

7076MI25

Caution

1. Service intervals are based on the hour meter reading.
2. The number of each item shows the lubrication point on the machine.
3. Stop engine while filling oil, and use no open flames.
4. For other details, refer to the service manual.

Service interval	No.	Description	Service action	Oil symbol	Capacity l (U.S.gal)	Service points No.
10 Hours or daily	1	Hydraulic oil level	Check, Add	HO	75(19.8)	1
	2	Engine oil level	Check, Add	EO	11.6(3.1)	1
	4	Radiator coolant	Check, Add	C	11(2.9)	1
	5	Prefilter	Check, Drain	-	-	1
	6	Fan belt tension and damage	Check, Adjust	-	-	1
50 Hours or weekly	7	Attachment pins	Check, Add	PGL	-	17
	8	Dozer blade	Check, Add	PGL	-	4
	9	Fuel tank(water, sediment)	Check, Clean	-	-	1
	10	Swing bearing grease	Check, Add	PGL	-	3
	11	Swing reduction gear case	Check, Add	GO	1.5(0.4)	1
250 Hours	14	Track tension	Check, Adjust	-	-	2
	15	Battery(Electrolyte, voltage)	Check, Add	-	-	2
	17	Air breather element	Replace	-	-	1
500 Hours	21	Air con & Heater outer filter	Check, Clean	-	-	1
	2	Engine oil	Change	EO	11.6(3.1)	1
	3	Engine oil filter	Replace	-	-	1
	5	Prefilter	Replace	-	-	1
	20	Air cleaner element(Primary)	Clean	-	-	1
	22	Fuel filter element	Replace	-	-	1
1000 Hours	23	Radiator and oil cooler	Check, Clean	-	-	2
	11	Swing reduction gear case	Change	GO	1.5(0.4)	1
	13	Swing gear and pinion	Change	PGL	1.8kg(4.0lb)	1
	16	Hydraulic oil return filter	Replace	-	-	1
	19	Line filter element	Replace	-	-	1
2000 Hours	24	Travel reduction gear case	Change	GO	1.2(0.32)	2
	1	Hydraulic oil level	Change	HO	75(19.8)	1
	4	Radiator coolant	Change	C	11(2.9)	1
As required	18	Hydraulic oil suction strainer	Check, Clean	-	-	1
	17	Air conditioner & heater fresh air filter	Replace	-	-	1
	17	Air conditioner & heater recirculation filter	Clean, Replace	-	-	1
	19	Air cleaner element(Primary, safety)	Check, Replace	-	-	2

※ Oil symbol

Please refer to the recommended lubricants for specification.

DF : Diesel fuel

GO : Gear oil

HO : Hydraulic oil

C : Coolant

PGL : Grease

EO : Engine oil