

5. MAINTENANCE CHART

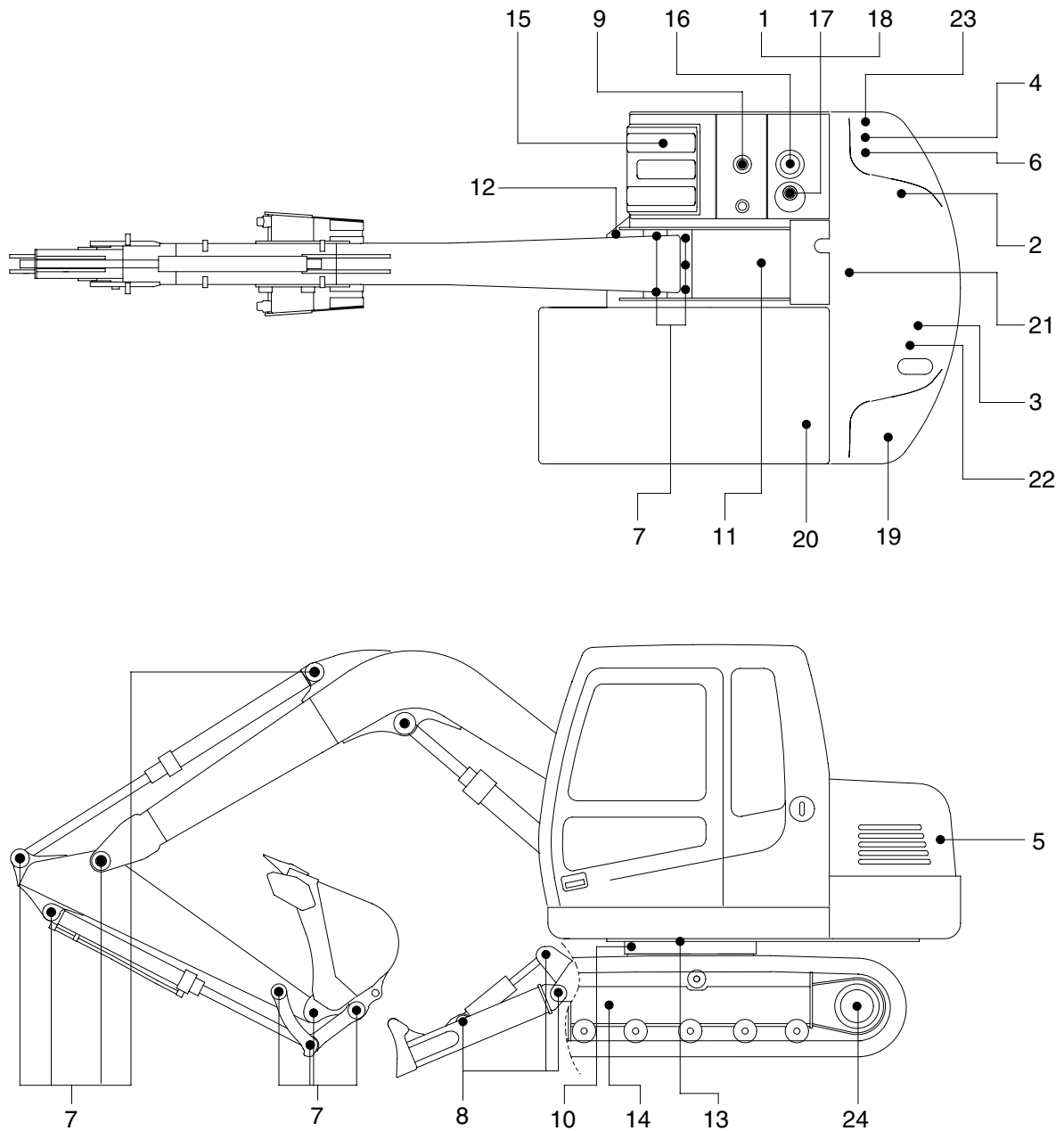

7076MI25

Caution

1. Service intervals are based on the hour meter reading.
2. The number of each item shows the lubrication point on the machine.
3. Stop engine while filling oil, and use no open flames.
4. For other details, refer to the service manual.

Service interval	No.	Description	Service action	Oil symbol	Capacity l (U.S.gal)	Service points No.
10 Hours or daily	1	Hydraulic oil level	Check, Add	HO	75(19.8)	1
	2	Engine oil level	Check, Add	EO	12(3.17)	1
	4	Radiator coolant	Check, Add	C	11(2.9)	1
	5	Water separator	Check, Drain	-	-	1
	6	Fan belt tension and damage	Check, Adjust	-	-	1
50 Hours or weekly	7	Attachment pins	Check, Add	PGL	-	17
	8	Dozer blade	Check, Add	PGL	-	4
	9	Fuel tank(water, sediment)	Check, Clean	-	-	1
	10	Swing bearing grease	Check, Add	PGL	-	3
	11	Swing reduction gear case	Check, Add	GO	1.5(0.4)	1
	12	Swing reduction gear grease	Check, Add	PGL	0.2kg(0.4lb)	1
250 Hours	14	Track tension	Check, Adjust	-	-	2
	15	Battery(Electrolyte, voltage)	Check, Add	-	-	2
	16	Hydraulic oil return filter	Replace	-	-	1
	17	Air breather element	Replace	-	-	1
	19	Line filter element	Replace	-	-	1
500 Hours	20	Air con & Heater outer filter	Check, Clean	-	-	1
	2	Engine oil	Change	EO	12(3.17)	1
	3	Engine oil filter	Replace	-	-	1
	21	Air cleaner element(Primary)	Clean	-	-	1
	22	Fuel filter element	Replace	-	-	1
1000 Hours	23	Radiator and oil cooler	Check, Clean	-	-	2
	11	Swing reduction gear case	Change	GO	1.5(0.4)	1
	13	Swing gear and pinion	Change	PGL	1.8kg(4.0lb)	1
2000 Hours	24	Travel reduction gear case	Change	GO	1.2(0.32)	2
	1	Hydraulic oil level	Change	HO	75(19.8)	1
	4	Radiator coolant	Change	C	11(2.9)	1
As required	18	Hydraulic oil suction strainer	Check, Clean	-	-	1
	17	Air conditioner & heater fresh air filter	Replace	-	-	1
	17	Air conditioner & heater recirculation filter	Clean, Replace	-	-	1
	19	Air cleaner element(Primary, safety)	Check, Replace	-	-	2

※ **Oil symbol**

Please refer to the recommended lubricants for specification.

DF : Diesel fuel GO : Gear oil
HO : Hydraulic oil C : Coolant
PGL : Grease EO : Engine oil