

## 5. MAINTENANCE CHART

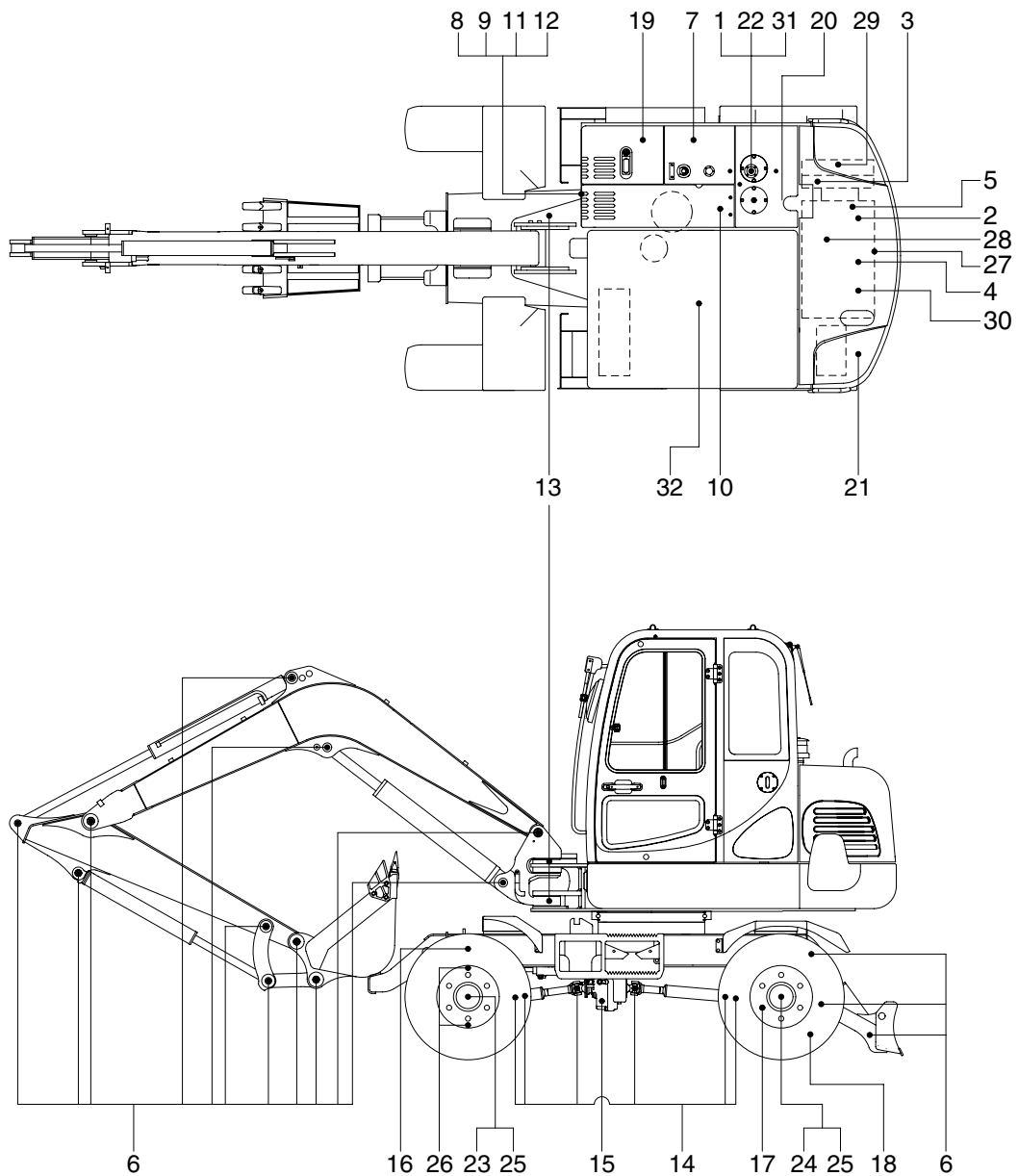

55W76MA04

### Caution

1. Service intervals are based on the hour meter reading.
2. The number of each item shows the lubrication point on the machine.
3. Stop engine while filling oil, and use no open flames.
4. For other details, refer to the service manual.

Service interval	No.	Description	Service action	Oil symbol	Capacity l (U.S.gal)	Service points No.
10Hours or daily	1	Hydraulic oil level	Check, Add	HO	70(18.5)	1
	2	Engine oil level	Check, Add	EO	9.2(2.4)	1
	3	Radiator coolant level	Check, Add	C	10(2.6)	1
	4	Water separator	Check, Drain	-	-	1
	5	Fan belt tension and damage	Check	-	-	1
50 Hours or weekly	6	Attachment pins	Lubricate	PGL	-	16
	7	Fuel tank strainer and drain	Check, Clean	-	-	1
	8	Swing bearing grease	Lubricate	PGL	-	1
	10	Swing reduction gear case oil level	Check, Add	GO	1.5(0.4)	1
	11	Swing gear and pinion	Lubricate	PGL	-	1
	12	Boom swing cylinder	Lubricate	PGL	-	1
	13	Attachment pins(Swivel type)	Check, Add	PGL	-	3
	14	Drive shaft(Flange bearing)	Lubricate	PGL	-	6
	15	Gear box case	Check, Add	GO	1.84(0.49)	1
	16	Front axle pivot pin bushing	Check, Add	PGL	-	1
	17	Wheel nut	Check, Tighten	-	-	24
250 Hours	18	Tire air pressure	Check, Add	-	-	4
	19	Battery(Electrolyte, Voltage)	Check	-	-	1
	22	Air breather element	Replace	-	-	1
	23	Front axle differential gear case	Check, Add	GO	4.8(1.27)	1
	24	Rear axle differential gear case	Check, Add	GO	3.9(1.0)	1
	25	Axle planetary gear case(Front, rear)	Check, Add	GO	0.45(0.12)	4
500 Hours	26	Front axle steering case	Lubricate	PGL	-	4
	2	Engine oil	Change	EO	11.6(3.1)	1
	27	Engine oil filter	Replace	-	-	1
	28	Air cleaner element	Check, Clean	-	-	1
	29	Radiator and cooler fin	Check, Clean	-	-	2
1000 Hours	30	Fuel filter & fuel prefilter element	Replace	-	-	1
	10	Swing reduction gear case oil level	Change	GO	1.5(0.4)	1
	15	Gear box case	Change	GO	1.84(0.49)	1
	20	Hydraulic oil return filter	Replace	-	-	1
	21	Pilot line filter element	Replace	-	-	1
	23	Front axle differential gear case	Change	GO	4.8(1.27)	1
	24	Rear axle differential gear case	Change	GO	3.9(1.0)	1
25	Axle planetary gear case(Front, rear)	Change	GO	0.45(0.12)	4	
2000 Hours	1	Hydraulic tank oil	Change	HO	70(18.5)	1
	3	Radiator coolant	Change	C	10(2.6)	1
	31	Hydraulic oil suction strainer	Check, Clean	-	-	1
As required	28	Air cleaner element(Primary, safety)	Check, Replace	-	-	2
	32	Air conditioner filter	Check, Replace	-	-	1

★ Severely dusty area operation only.

※ Oil symbol

Please refer the recommended lubricants for specification.

DF : Diesel fuel      GO : Gear oil      HO : Hydraulic oil  
C : Coolant      PGL : Grease      EO : Engine oil