

5. MAINTENANCE CHART

8

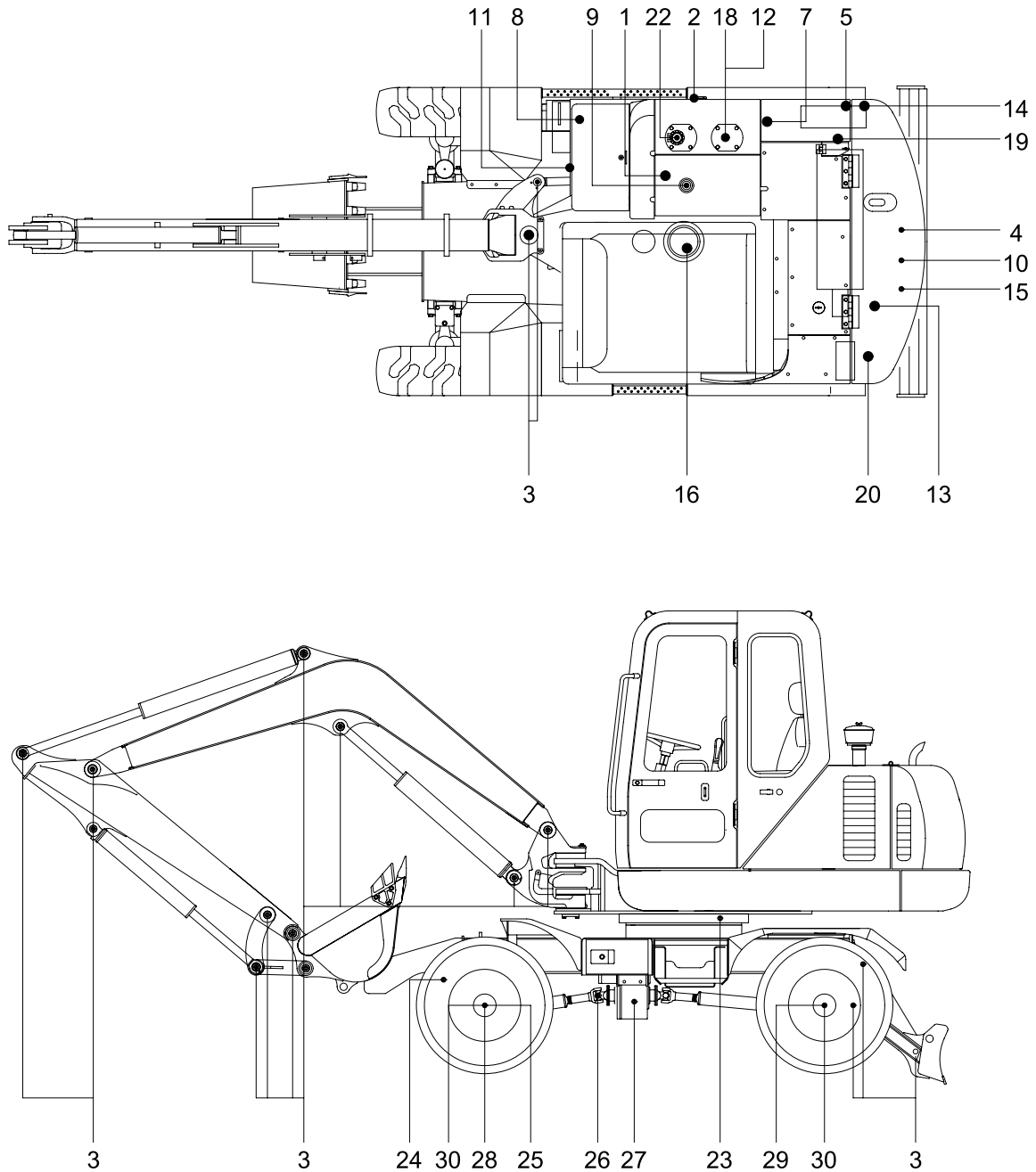

55W36M199

Caution

1. Service intervals are based on the hour meter reading.
2. The number of each item shows the lubrication point on the machine.
3. Stop engine while filling oil, and use no open flames.
4. For other details, refer to the service manual.

Service interval	No.	Description	Service action	Oil symbol	Capacity l (U.S.gal)	Service points No.
10 Hours or daily	1	Fuel tank	Check, Refill	DF	125(33)	1
	2	Hydraulic oil level	Check, Add	HO	80(21)	1
	4	Engine oil level	Check, Add	EO	9.7(2.6)	1
	5	Radiator coolant	Check, Add	C	8.0(2.1)	1
	7	Water separator	Drain	-	-	1
	13	★Air cleaner element	Check, Clean	-	-	2
50 Hours or weekly	3	Work equipment(Pin and bushing)	Lubricate	PGL	-	17
	9	Fuel tank stainer & drain	Check, Clean	-	-	1
	11	Swing bearing	Lubricate	PGL	-	1
	13	Air cleaner element	Check, ckean	-	-	2
	16	Swing reduction gear oil level	Check, Add	GO	0.6(0.16)	1
	24	Front axle pivot pin	Lubricate	PGL	-	1
	25	Front axle king pin	Lubricate	PGL	-	4
26	Drive shaft(Joint)	Lubricate	PGL	-	6	
250 Hours	4	Engine oil level	Chabge	EO	16.4(4.3)	2
	8	Battery(Electrolyte)	Check, Refill	-	-	2
	10	Engine oil filter	Replace	-	-	1
	12	Hydraulic oil return filter	Replace	-	-	1
	13	Air cleaner element	Replace	-	-	2
	20	Pilot line filter element	Replace	-	-	1
	22	Hydraulic tank air breather element	Replace	-	-	1
	27	Transfer box case	Check, Add	GO	2.5(0.7)	1
	28	Front axle differential gear case	Check, Add	GO	4.5(1.2)	1
	29	Rear axle differential gear case	Check, Add	GO	4.0(1.1)	1
	30	Axle planetary gear case(Front/Rear)	Check, Add	GO	0.35(0.1)	4
500 Hours	14	Radiator and cooler fin	Check, Clean	-	-	1
	15	Fuel filter element	Replace	-	-	1
1000 Hours	16	Swing reduction gear oil	Change	GO	0.6(0.16)	1
	19	Fan belt tension & pinion	Check, Adjust	-	-	1
	23	Swing bearing & pinion	Change	PGL	-	1
	27	Transfer box case	Change	GO	2.5(0.7)	1
	28	Front axle differ ential gear case	Change	GO	4.5(1.2)	1
	29	Rear axle differential gear case	Change	GO	4.0(1.1)	1
30	Axle planetary gear case(Front/Rear)	Change	GO	0.35(0.1)	4	
2000 Hours	2	Hydraulic tank oil level	Change	HO	80(21)	1
	5	Radiator coolant	Change	C	8.0(2.1)	1
	18	Hydraulic suction strainer	Check, Clean	-	-	1

※ Oil symbol

Please refer to the recommended lubricants for specification.

DF : Diesel fuel

GO : Gear oil

HO : Hydraulic oil

C : Coolant

PGL : Grease

EO : Engine oil