

## 5. MAINTENANCE CHART

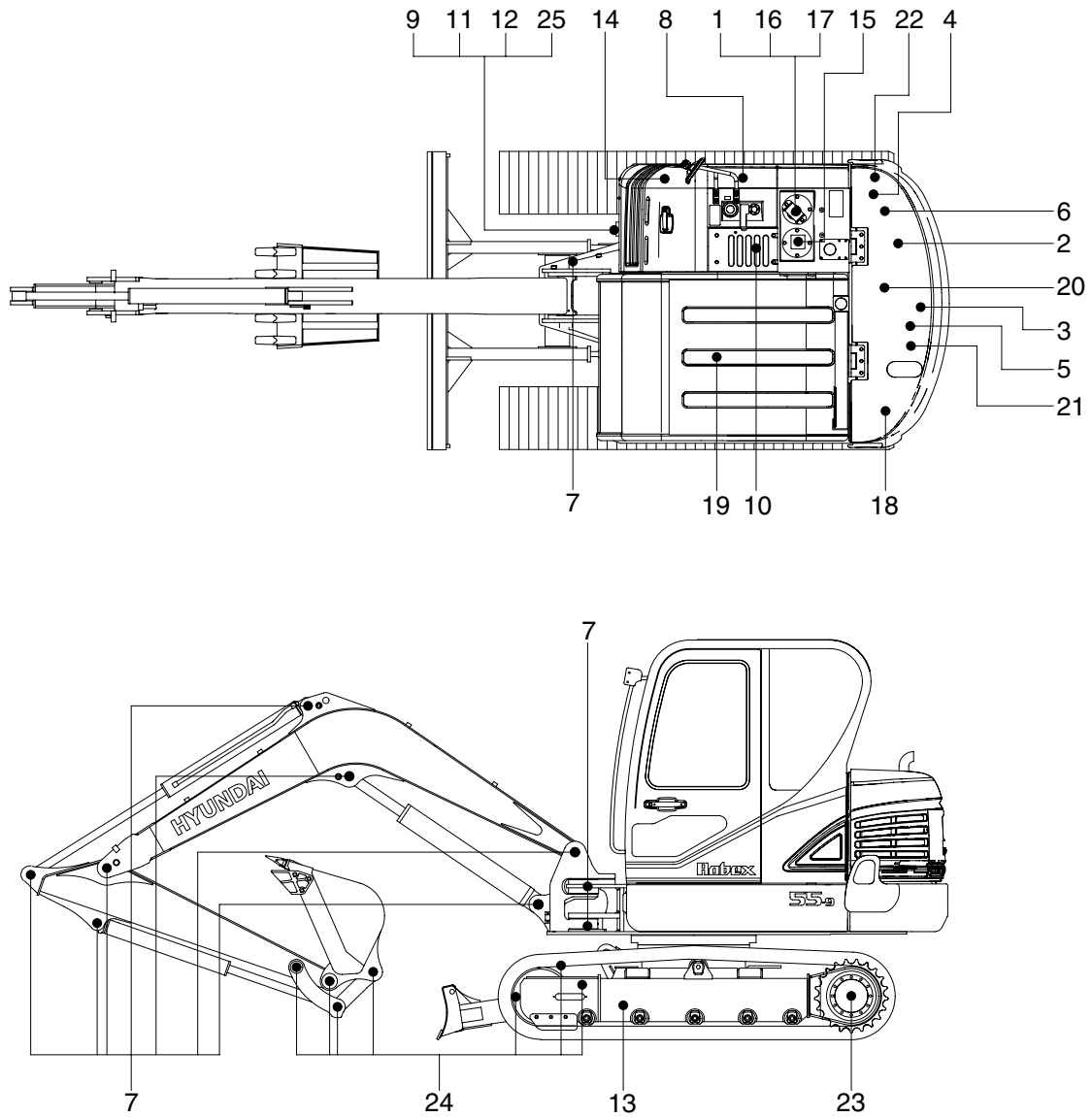

5596MA03

### Caution

1. Service intervals are based on the hour meter reading.
2. The number of each item shows the lubrication point on the machine.
3. Stop engine while filling oil, and use no open flames.
4. For other details, refer to the service manual.

Service interval	No.	Description	Service action	Oil symbol	Capacity / (U.S.gal)	Service points No.
10 Hours or daily	1	Hydraulic oil level	Check, Add	HO	70 (18.5)	1
	2	Engine oil level	Check, Add	EO	11.6 (3.1)	1
	4	Radiator coolant	Check, Add	C	9.5 (2.5)	1
	5	Prefilter (water, element)	Check, Clean	-	-	1
	6	Fan belt tension and damage	Check, Adjust	-	-	1
50 Hours or weekly	8	Fuel tank (water, sediment)	Check, Clean	-	-	1
	9	Swing bearing	Lubricate	PGL	-	3
	10	Swing drive gear case (gear oil)	Check, Add	GO	1.5 (0.4)	1
	12	Swing gear and pinion	Check, Add	PGL	-	1
	13	Track tension	Check, Adjust	PGL	-	2
	24	Bucket linkage & blade pin	Lubricate	PGL	-	7
250 Hours	25	Boom swing cylinder	Lubricate	PGL	-	1
	7	Attachment pin	Lubricate	PGL	-	10
	14	Battery (voltage)	Check, Clean	-	-	1
	16	Air breather element	Replace	-	-	1
500 Hours	19	Air conditioner filter (outer)	Clean	-	-	1
	2	Engine oil	Change	EO	11.6 (3.1)	1
	3	Engine oil filter	Replace	-	-	1
	5	Prefilter (water, element)	Replace	-	-	1
	20	Air cleaner element (primary)	Clean	-	-	1
	21	Fuel filter element	Replace	-	-	1
1000 Hours	22	Radiator, cooler fin and charge air cooler	Check, Clean	-	-	3
	9	Swing drive gear case (gear oil)	Change	GO	1.5 (0.4)	1
	11	Swing drive gear case (grease)	Change	PGL	0.35 (0.09)	1
	15	Hydraulic oil return filter	Replace	-	-	1
	18	Line filter element	Replace	-	-	1
2000 Hours	23	Final drive gear case	Change	GO	1.2 (0.3)	2
	1	Hydraulic oil*1	Change	HO	70 (18.5)	1
	4	Radiator coolant	Change	C	9.5 (2.5)	1
5000 Hours	17	Hydraulic oil suction strainer	Check, Clean	-	-	1
	1	Hydraulic oil*2	Change	HO	70 (18.5)	1
As required	19	Air conditioner filters	Check, Clean	-	-	2
	20	Air cleaner element (safety/primary)	Check, Clean	-	-	2

\*1 : Conventional hydraulic oil

\*2 : Hyundai genuine long life hydraulic oil

※ Oil symbol

Please refer to the recommended lubricants for specification.

DF : Diesel fuel

GO : Gear oil

HO : Hydraulic oil

C : Coolant

PGL : Grease

EO : Engine oil