

4. LEVERS AND PEDALS

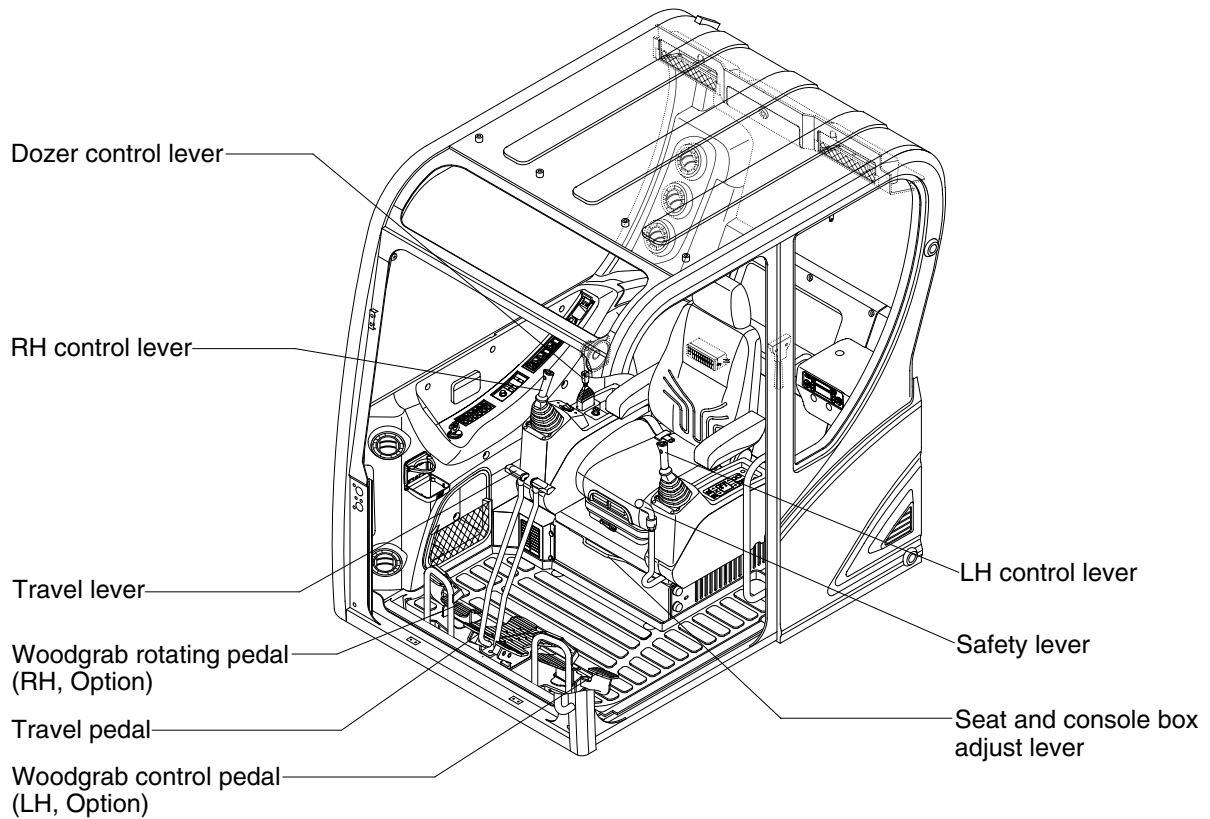

5593CD22A

1) LH CONTROL LEVER

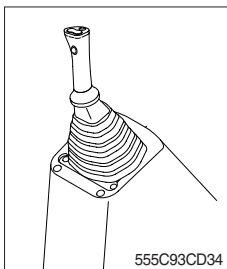

- (1) This joystick is used to control the swing and the arm.
- (2) Refer to **operation of working device** in chapter 4 for details.

2) RH CONTROL LEVER

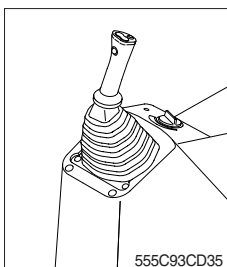

- (1) This joystick is used to control the boom and the bucket.
- (2) Refer to **operation of working device** in chapter 4 for details.

3) SAFETY LEVER

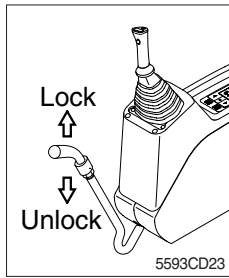

- (1) LH, RH control levers and dozer control lever are disabled from operation by locating the lever to lock position as shown.
 - ※ **Be sure to raise the lever to LOCK position when leaving from operator's seat.**
 - (2) By pushing lever to UNLOCK position, machine is operational.
 - ※ **Do not use the safety lever for handle when getting on or off the machine.**
- ▲ **The machine is able to travel even when the safety lever is in the LOCK position.**

4) TRAVEL LEVER

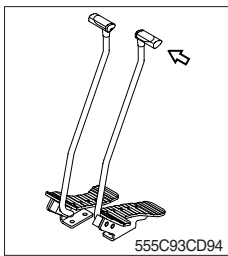

- (1) This lever is mounted on travel pedal and used for traveling by hand. The operation principle is same as the travel pedal.
- (2) Refer to **traveling of the machine** in chapter 4 for details.

5) TRAVEL PEDAL

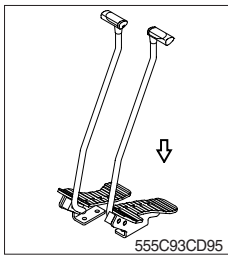

- (1) This pedal is used to move the machine forward or backward.
- (2) If left side pedal is pressed, left track will move.
If right side pedal is pressed, right track will move.
- (3) Refer to **traveling of machine** in chapter 4 for details.

6) SEAT AND CONSOLE BOX ADJUST LEVER

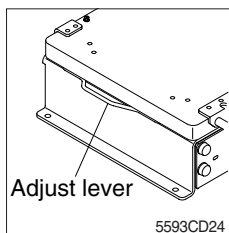

- (1) This lever is used to move the seat and console box to fit the contours of the operator's body.
- (2) Pull the lever to adjust forward or backward over 90mm(3.5").

7) DOZER CONTROL LEVER

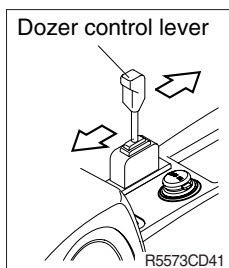

- (1) This lever is used to operate the dozer blade.
- (2) If the lever is pushed forward, the dozer blade will be going down.
If the lever is pulled back, the dozer blade will be going up.

8) WOODGRAB ADJUST PEDAL (option)

These pedals are used to operate the woodgrab if equipped.

Also, the switched are used to operate the woodgrab.

Refer to page 3-14 and 4-7.

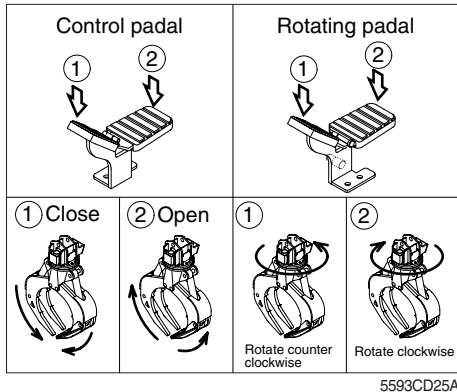

(1) Standard (factory spec)

- ① If the part ① of the left pedal is pressed, the woodgrab is closed and if the part ② is pressed, the woodgrab is open.
- ② If the part ① of the right pedal is pressed, the woodgrab rotates counterclockwise and if the part ② is pressed, the woodgrab rotates clockwise.

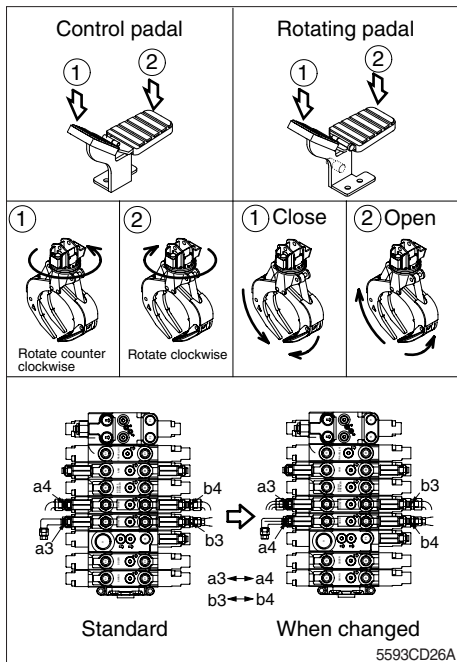

(2) When changed

- ① If the pilot hoses are altered, controlling the woodgrab can be exchanged.
 - ② If the part ① of the left pedal is pressed, the woodgrab rotates counterclockwise and if the part ② is pressed, the woodgrab rotates clockwise.
 - ③ If the part ① of the right pedal is pressed, the woodgrab is closed and if the part ② is pressed, the woodgrab is open.
- ※ To change the operational mode, you need to exchange the ports of hoses between main control valve and pedals as illustration (a3 ↔ a4, b3 ↔ b4).
- ※ Be sure to relieve the pressure in the system before exchanging the ports of the hoses.