

2. DIMENSION AND WEIGHT

1) ROBEX 35Z-9

(1) Base machine

Mark	Description	Unit	Specification
L	Length	mm (ft-in)	2550 (8' 4")
H	Height	mm (ft-in)	2500 (8' 2")
W	Width	mm (ft-in)	1740 (5' 9")
Wt	Weight	kg (lb)	3260 (7190)

※ With 300 mm (12") rubber shoes and 420 kg (925 lb) counterweight.

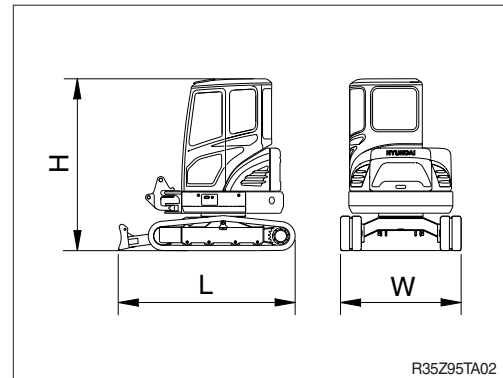

(2) Boom assembly

Mark	Description	Unit	Specification
L	Length	mm (ft-in)	2610 (8' 7")
H	Height	mm (ft-in)	850 (2' 9")
W	Width	mm (ft-in)	280 (11")
Wt	Weight	kg (lb)	175 (386)

※ 2.5 m (8' 2") boom with arm cylinder (included piping and pins).

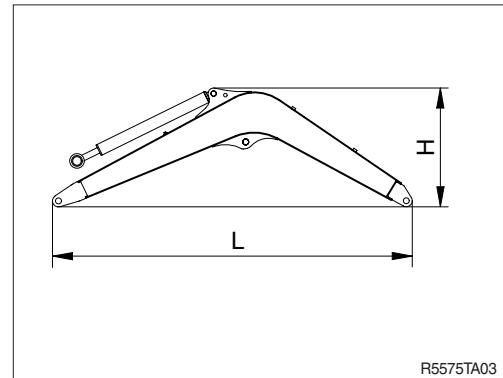

(3) Arm assembly

Mark	Description	Unit	Specification
L	Length	mm (ft-in)	1690 (5' 7")
H	Height	mm (ft-in)	510 (1' 8")
W	Width	mm (ft-in)	170 (7")
Wt	Weight	kg (lb)	118 (260)

※ 1.3 m (4' 3") arm with bucket cylinder (included linkage and pins).

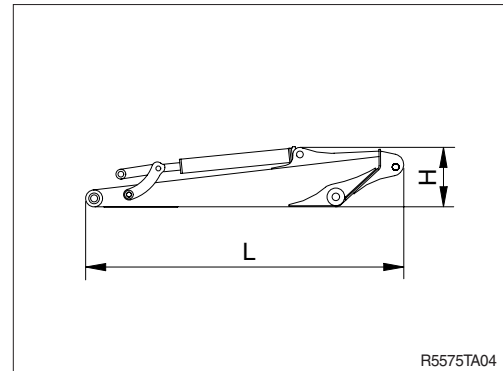

(4) Bucket assembly

Mark	Description	Unit	Specification
L	Length	mm (ft-in)	790 (2' 7")
H	Height	mm (ft-in)	500 (1' 8")
W	Width	mm (ft-in)	610 (2' 0")
Wt	Weight	kg (lb)	80 (176)

※ 0.11 m³ (0.14 yd³) SAE heaped bucket (included tooth and side cutters).

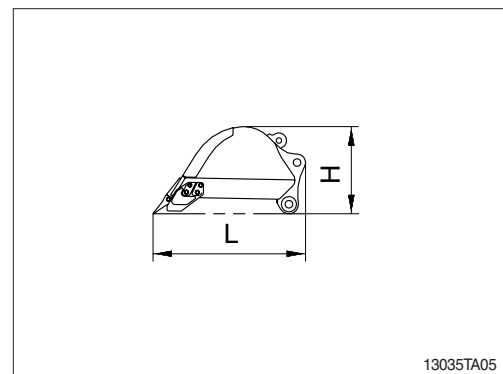

(5) Boom cylinder

Mark	Description	Unit	Specification
L	Length	mm (ft-in)	990 (3' 3")
H	Height	mm (ft-in)	120 (5")
W	Width	mm (ft-in)	250 (10")
Wt	Weight	kg (lb)	35 (80)

※ Included piping.

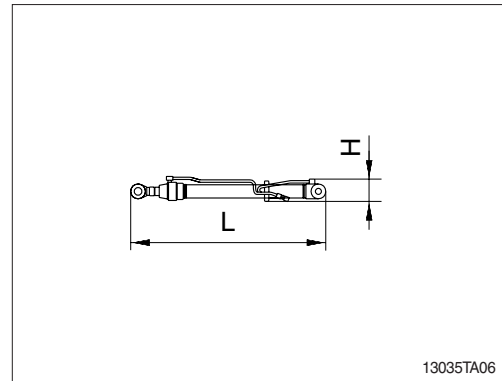

(6) Cab assembly

Mark	Description	Unit	Specification
L	Length	mm (ft-in)	1300 (4' 3")
H	Height	mm (ft-in)	1620 (5' 4")
W	Width	mm (ft-in)	1110 (3' 8")
Wt	Weight	kg (lb)	230 (507)

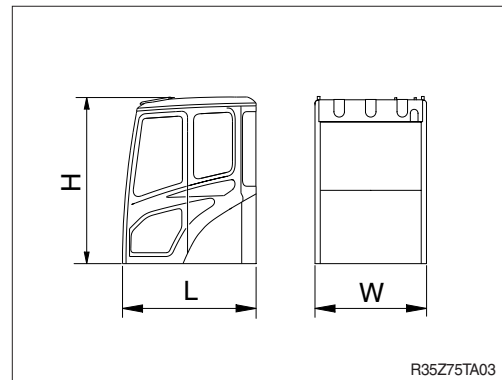

(7) Canopy assembly

Mark	Description	Unit	Specification
L	Length	mm (ft-in)	1590 (5' 3")
H	Height	mm (ft-in)	1240 (4' 1")
W	Width	mm (ft-in)	935 (3' 1")
Wt	Weight	kg (lb)	92 (203)

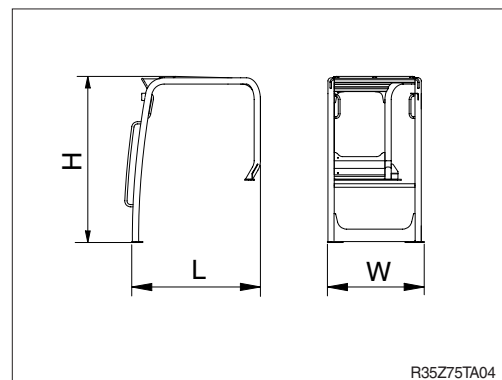

(8) Counterweight

Mark	Description	Unit	Specification
L	Length	mm (ft-in)	1430 (4' 8")
H	Height	mm (ft-in)	310 (12")
W	Width	mm (ft-in)	565 (1' 10")
Wt	Weight	kg (lb)	420 (925)

