

## 2. SPECIFICATIONS

### 1) 2.5 m ( 8' 2") MONO BOOM, 1.3 m ( 4' 3") ARM, WITH BOOM SWING POST

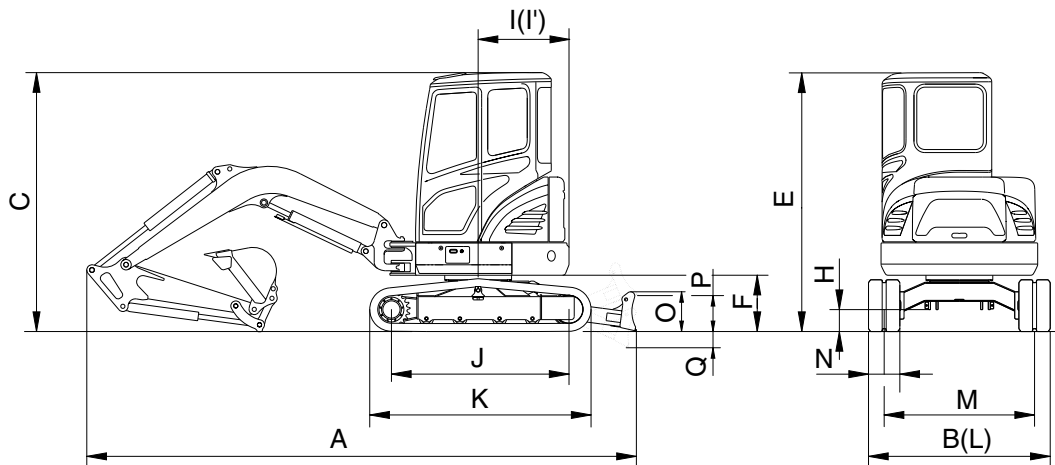

R35Z72SP02

Description		Unit	Specification
Operating weight		kg (lb)	3650 (8050)
Bucket capacity (SAE heaped), standard		m <sup>3</sup> (yd <sup>3</sup> )	0.11 (0.14)
Overall length	A	mm (ft-in)	4790 (15' 9")
Overall width, with 300 mm shoe	B		1740 ( 5' 9")
Overall height	C		2500 ( 8' 2")
Overall height of cab	E		2500 ( 8' 2")
Ground clearance of counterweight	F		540 ( 1' 9")
Minimum ground clearance	H		290 ( 0' 11")
Rear-end distance	I		870 ( 2' 10")
Rear-end swing radius	I'		870 ( 2' 10")
Distance between tumblers	J		1700 ( 5' 7")
Undercarriage length	K		2130 ( 7' 0")
Undercarriage width	L		1740 ( 5' 9")
Track gauge	M		1440 ( 4' 9")
Track shoe width, standard	N		300 ( 1' 0")
Height of blade	O		370 ( 1' 3")
Ground clearance of blade up	P		375 ( 1' 3")
Depth of blade down	Q		390 ( 1' 3")
Travel speed (low/high)			km/hr (mph)
Swing speed		rpm	9.5
Gradeability		Degree (%)	30 (58)
Ground pressure (300 mm shoe)		kgf/cm <sup>2</sup> (psi)	0.34 (4.83)
Max traction force		kg (lb)	3100 (6835)