

5. MAINTENANCE CHART

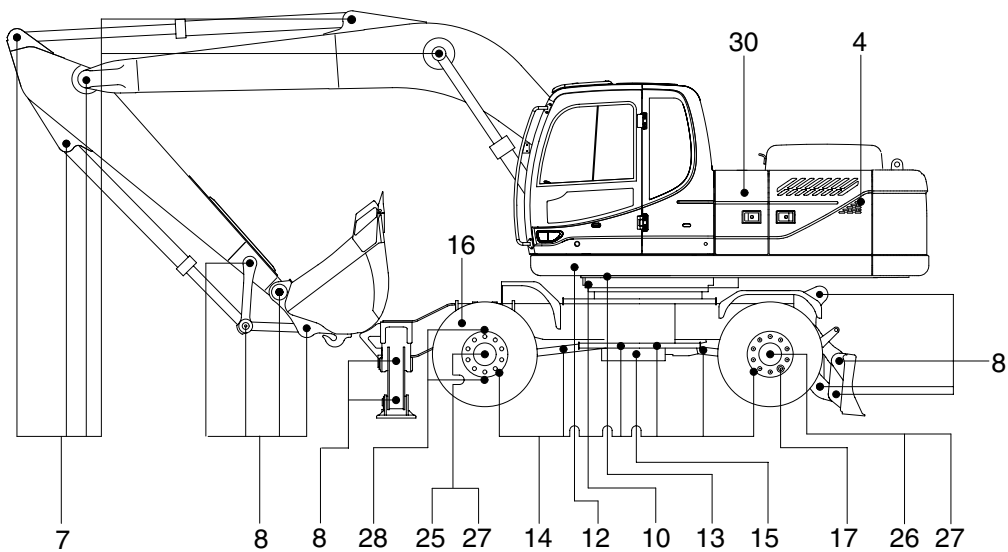
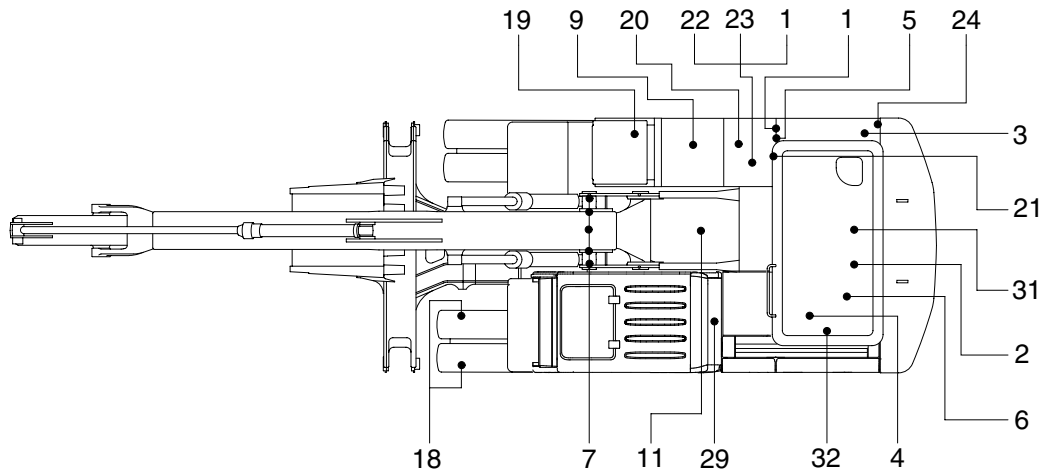

20W96MA05

Caution

1. Service intervals are based on the hour meter reading.
2. The number of each item shows the lubrication point on the machine.
3. Stop engine while filling oil, and use no open flames.
4. For other details, refer to the service manual.

Service interval	No.	Description	Service action	Oil symbol	Capacity l (U.S.gal)	Service points No.
10 Hours or daily	1	Hydraulic oil level	Check, Add	HO	165 (43.6)	1
	2	Engine oil level	Check, Add	EO	24 (6.3)	1
	4	Radiator coolant level	Check, Add	C	35 (9.2)	1
	5	Prefilter (water, element)	Check, Clean	-	-	1
	6	Fan belt tension & damage	Check, Clean	-	-	1
	50 Hours or weekly	8	Bucket linkage & lower frame pins	Check, Add	PGL	-
9		Fuel tank (water, sediment)	Check, Clean	DF	-	1
10		Swing bearing grease	Check, Add	PGL	-	3
11		Swing reduction gear case	Check, Add	GO	5.0 (1.3)	1
14		Drive shaft grease (flange bearing)	Check, Add	PGL	-	6
15		Transmission case	Check, Add	EO	2.5 (0.66)	1
16		Front axle pivot pin bushing	Check, Add	PGL	-	1
17		Wheel nuts	Check, Tighten	-	-	40
250 Hours	7	Attachment pins	Check, Add	PGL	-	11
	19	Battery (voltage)	Check	-	-	1
	22	Air breather element	Replace	-	-	1
	25	Front axle differential gear case	Check, Add	GO	9.6 (2.54)	1
	26	Rear axle differential gear case	Check, Add	GO	13.1 (3.46)	1
	27	Axle planetary gear case (front, rear)	Check, Add	GO	2.5 (0.66)	4
	28	Front axle steering case	Check, Add	PGL	-	4
	29	Aircon & heater fresh air filter	Check, Clean	-	-	1
500 Hours	2	Engine oil	Change	EO	24 (6.3)	1
	3	Engine oil filter	Replace	-	-	1
	5	Prefilter (water, element)	Replace	-	-	1
	30	Air cleaner element (primary)	Check, Clean	-	-	1
	31	Fuel filter element	Replace	-	-	1
	32	Radiator, oil cooler, charge air cooler	Check, Clean	-	-	3
	1000 Hours	11	Swing reduction gear case	Change	GO	2.5 (0.7)
12		Swing reduction gear grease	Change	PGL	1.2 kg (2.6 lb)	1
13		Swing gear and pinion grease	Change	PGL	6.2 kg (13.7 lb)	1
15		Transmission case	Change	EO	2.5 (0.66)	1
20		Hydraulic oil return filter	Replace	-	-	1
21		Drain filter cartridge	Replace	-	-	1
24		Pilot line filter element	Replace	-	-	1
25		Front axle differential gear case	Change	GO	9.6 (2.54)	1
26		Rear axle differential gear case	Change	GO	13.1 (3.46)	1
27		Axle planetary gear case (front, rear)	Change	PGL	2.5 (0.66)	4
2000 Hours	1	Hydraulic oil * ¹	Change	HO	165 (43.6)	1
	4	Radiator coolant	Change	C	35 (9.2)	1
	23	Hydraulic oil suction strainer	Check, Clean	-	-	1
5000 Hours	1	Hydraulic oil * ²	Change	HO	165 (43.6)	1
As required	29	Aircon & heater fresh filter	Replace	-	-	1
	29	Aircon & heater recirculation filter	Clean, Replace	-	-	1
	30	Air cleaner element (safety)	Replace	-	-	1
	30	Air cleaner element (primary)	Replace	-	-	1

*¹ Conventional hydraulic oil *² Hyundai genuine long life hydraulic oil

※ Oil symbol

Please refer to the recommended lubricants for specification.

DF : Diesel fuel GO : Gear oil HO : Hydraulic oil
C : Coolant PGL : Grease EO : Engine oil