

## 2. SPECIFICATIONS

### 1) 5.65m (18' 6") ONE PIECE BOOM, 2.90m (9' 6") ARM, FRONT OUTRIGGER AND REAR DOZER BLADE

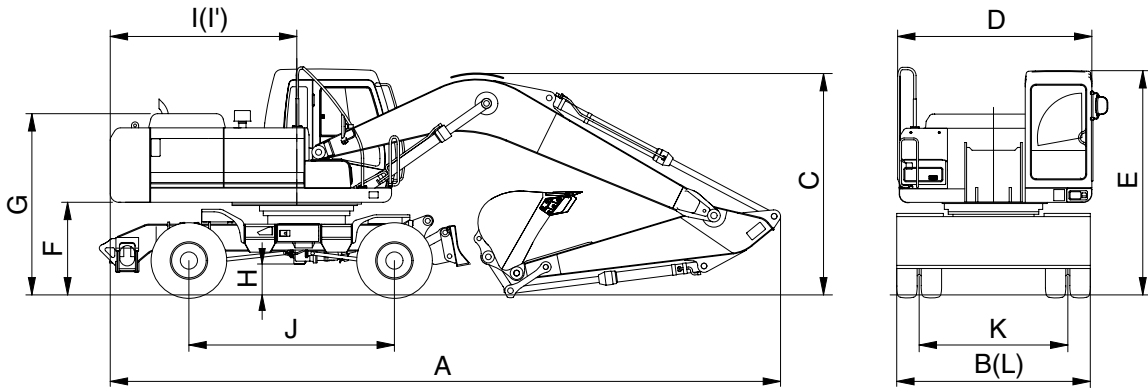

20W72SP02

Description		Unit	Specification
Operating weight		kg (lb)	20500(45200)
Bucket capacity(SAE heaped), standard		m <sup>3</sup> (yd <sup>3</sup> )	0.80 (1.05)
Overall length	A	mm (ft-in)	9490 (31' 2")
Overall width	B		2490 ( 8' 2")
Overall height of boom	C		3100 (10' 2")
Upperstructure width	D		2530 ( 8' 4")
Cab height	E		3180 (10' 5")
Ground clearance of counterweight	F		1310 ( 4' 3")
Engine cover height	G		2570 ( 8' 5")
Minimum ground clearance	H		345 ( 1' 2")
Rear-end distance	I		2765 ( 9' 1")
Rear-end swing radius	I'		2800 ( 9' 2")
Wheel base	J		2800 ( 9' 2")
Tread	K		1874 ( 6' 2")
Dozer blade width	L		2490 ( 8' 2")
Travel speed	Low		km/hr (mph)
	High	33 (20.5)	
Swing speed		rpm	12.5
Gradeability		Degree (%)	31.5 (61)