

## 5. MAINTENANCE CHART

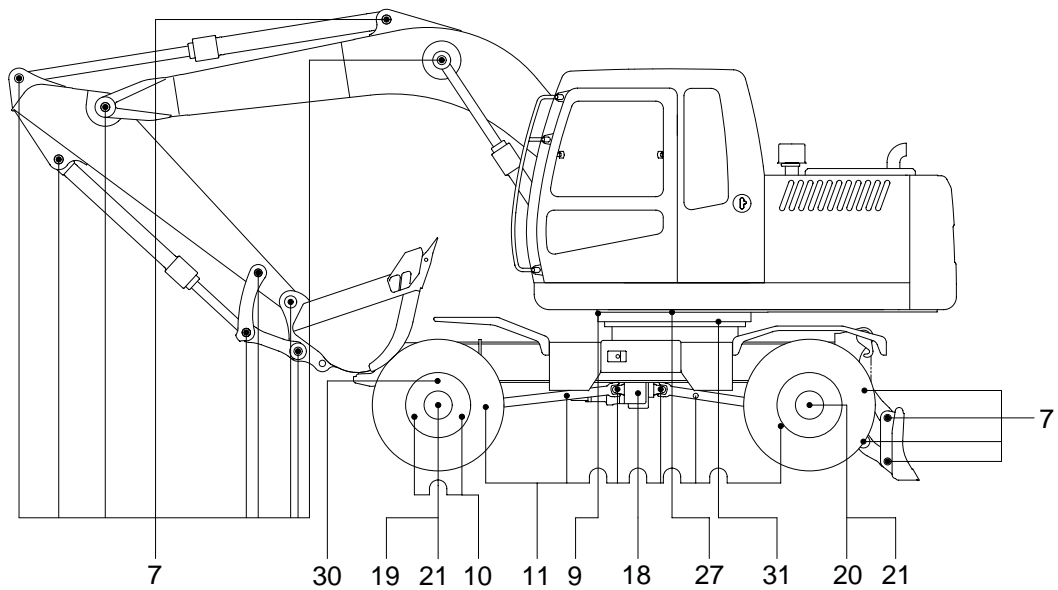
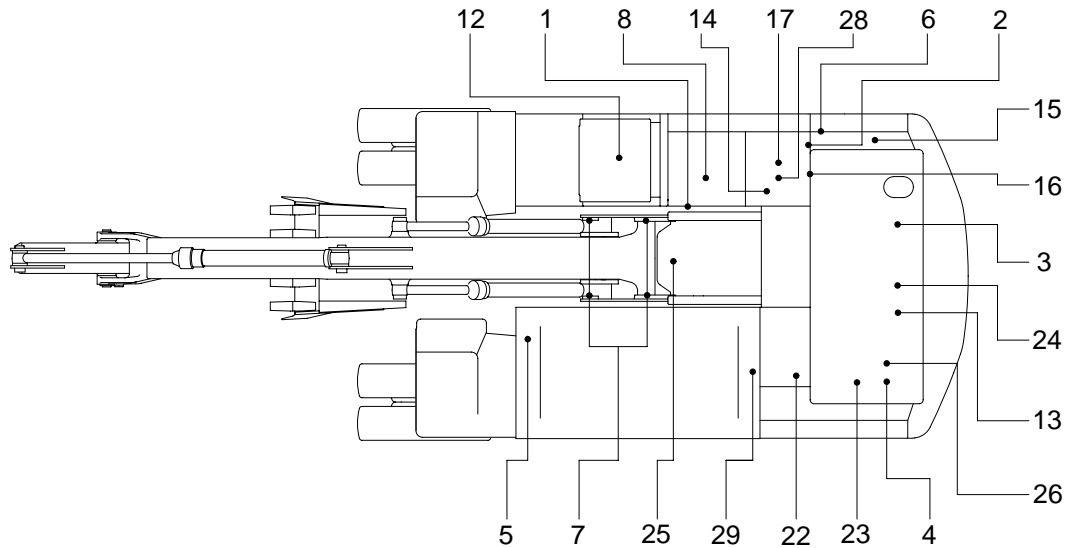

140W76M103

### Caution

1. Service intervals are based on the hour meter reading.
2. The number of each item shows the lubrication point on the machine.
3. Stop engine while filling oil, and use no open flames.
4. For other details, refer to the service manual.

Service interval	No.	Description	Service action	Oil symbol	Capacity l (U.S.gal)	Service points No.
10Hours or daily	1	Fuel tank	Check, Refill	DF	270(71.3)	1
	2	Hydraulic oil level	Check, Add	HO	124(32.7)	1
	3	Engine oil level	Check, Add	EO	15.3(4.0)	1
	4	Radiator coolant level	Check, Add	C	24(6.4)	1
	5	Control panel and pilot lamp	Check, Clean	-	-	1
	6	Water separator	Check, Drain	-	-	2
	7	Fan belt tension & damage	Check, Adjust	-	-	1
50 Hours or weekly	8	Attachment pins	Check, Add	PGL	-	See note
	9	Fuel tank strainer and drain	Check, Clean	-	-	1
	10	Swing bearing grease	Check, Add	PGL	-	3
	11	Drive shaft(joint)	Check, Add	PGL	-	6
	12	Transmission case	Check, Add	EO	3.2(0.85)	1
	13	Swing reduction gear case	Check, Add	GO(1)	2.5(0.66)	1
	14	Swing drive gear case	Check, Add	PGL	0.35(0.09)	1
250 Hours	15	Front axle trunnion bushing	Check, Add	PGL	-	2
	16	Battery(Electrolyte, voltage)	Check	-	-	2
	17	Hydraulic oil return filter	Replace	-	-	1
	18	Pilot line filter element	Replace	-	-	1
	19	Drain filter cartridge	Replace	-	-	1
	20	Air breather element	Replace	-	-	1
	21	Front axle differential gear case	Check, Add	GO(2)	-	1
	22	Rear axle differential gear case	Check, Add	GO(2)	-	1
	23	Axle planetary gear case(Front, rear)	Check, Add	GO(2)	-	4
	24	Front axle steering case	Check, Add	PGL	-	2
500 Hours	3	Engine oil level	Change	EO	15.3(4.0)	1
	25	Engine oil filter	Replace	-	-	1
	26	Air cleaner element(Primary)	Check, Clean	-	-	2
	27	Radiator and cooler fin	Check, Clean	-	-	1
	28	Fuel filter element	Replace	-	-	1
1000 Hours	12	Transmission case	Change	EO	3.2(0.85)	1
	13	Swing reduction gear case	Change	GO(1)	2.5(0.66)	1
	21	Front axle case	Change	GO(2)	7.75(2.0)	1
	22	Rear axle case	Change	GO(2)	8.4(2.2)	1
	23	Axle planetary gear case(Front, rear)	Change	GO	1.2(0.32)	4
	29	Swing gear and pinion	Change	PGL	4.4(1.2)	1
2000 Hours	2	Hydraulic tank oil level	Change	HO	124(32.7)	1
	4	Radiator coolant level	Change	C	24(6.4)	1
	30	Hydraulic oil suction strainer	Check, Clean	-	-	1
As required	31	Air conditioner filters	Check, Clean	-	-	2

Note : Pins of boom : Mono boom(17), Two pieces boom(20)

Pins of lower frame : Dozer blade(12), Outrigger(8)

★ Severely dusty area operation only.

※ Oil symbol

Please refer the recommended lubricants for specification.

DF : Diesel fuel      GO(1) : Gear oil(SAE 85W-140)      GO(2) : Gear oil(SAE 85W-90 LSD)

HO : Hydraulic oil      C : Coolant      PGL : Grease      EO : Engine oil