

3. MONITOR

- The monitor is adjustable.
 - Vertical : 14°
 - Horizontal : 30°



75793CD23

1) BUTTONS

(1) Menu button



- ① Main display to main menu, main menu to main display.
- ② AEB cancel button in AEB setting.

(2) Left move button



- ① Move in menu (left, up).

(3) Camera / ESC button



- ① Enter rear camera mode in main display.
- ② Cancel button except in main display (move previous menu).

(4) Right move / Buzzer stop button



- ① Move in menu (right, down).
- ② Buzzer stop.

(5) Enter button



- ① Select menu (enter).
- ② AEB cancel button in AEB setting.

2) MAIN MENU

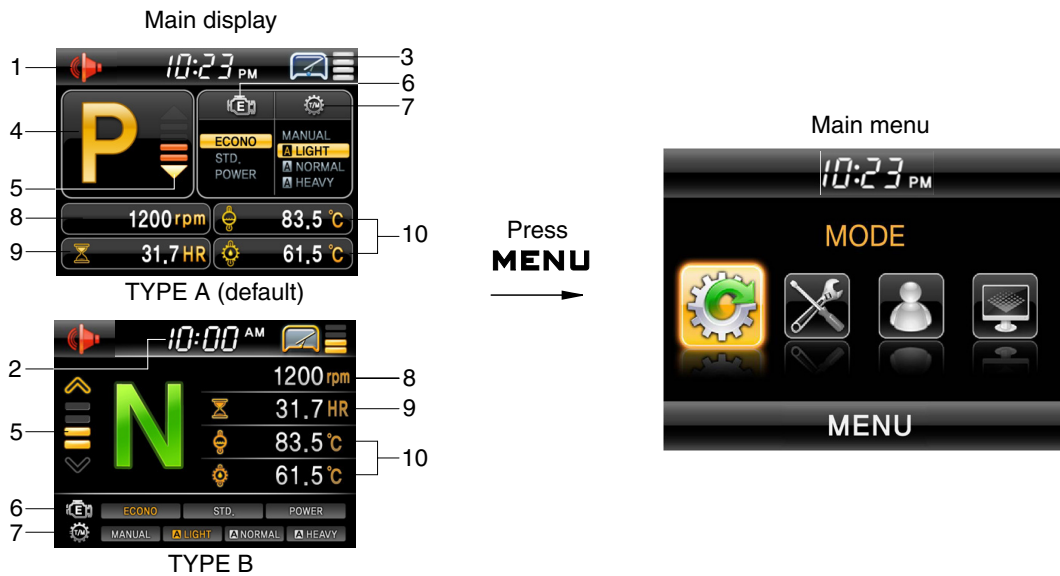





75793CD11

- | | | |
|---------------|---------------------|------------------------|
| 1 Buzzer | 5 Select gear | 9 Hour meter, odometer |
| 2 Clock | 6 Engine mode | 10 Monitoring |
| 3 Wiper speed | 7 Transmission mode | |
| 4 Actual gear | 8 Engine rpm | |

※ Display type can be changed by operator. See page 3-23.

(1) Structure

| No | Main menu | Sub menu | Description |
|----|--------------------------------------------------------------------------------------------------------------------|-----------------------------------------------------------------------------------------------------------------------------------------|------------------------------------------------------------------------------------------------------------------------------------------------------------------------------------------------------------------|
| 1 |  MODE 75793CD12 | Engine setting Kick down setting Wiper speed setting Fan-auto mode AEB setting Speed meter setting Sensor calibration | Engine warming up, Engine speed Mode 1 (down/up), Mode 2 (down only) 4 steps Interval and time setting AEB setting Pulse setting Boom/bucket angle, Boom pressure calibration |
| 2 |  MONITORING 75793CD13 | Fault code Machine monitoring Record monitoring | Machine, TCU, ECU, SCU Hyd temp, Battery, Coolant temp T/M oil temp, Weighing system Hour meter, ODO meter |
| 3 |  MANAGEMENT 75793CD14 | Machine security Maintenance Machine information Service contact Service | ESL system setting, Change password Replacement, Change interval (oils and filters) Version, Status Service contact S/W download |
| 4 |  DISPLAY SET UP 75793CD13 | Clock Display setting Unit setting Rear camera setting Language setting | Clock Brightness setting (Manual/Automatic) Type display (A or B type) Temp (°F/°C), Distance (km/mile), Pressure (bar, Mpa, kgf/m², psi) Reverse mode, Active camera, Display order 12 languages |

(2) Mode

① Engine setting

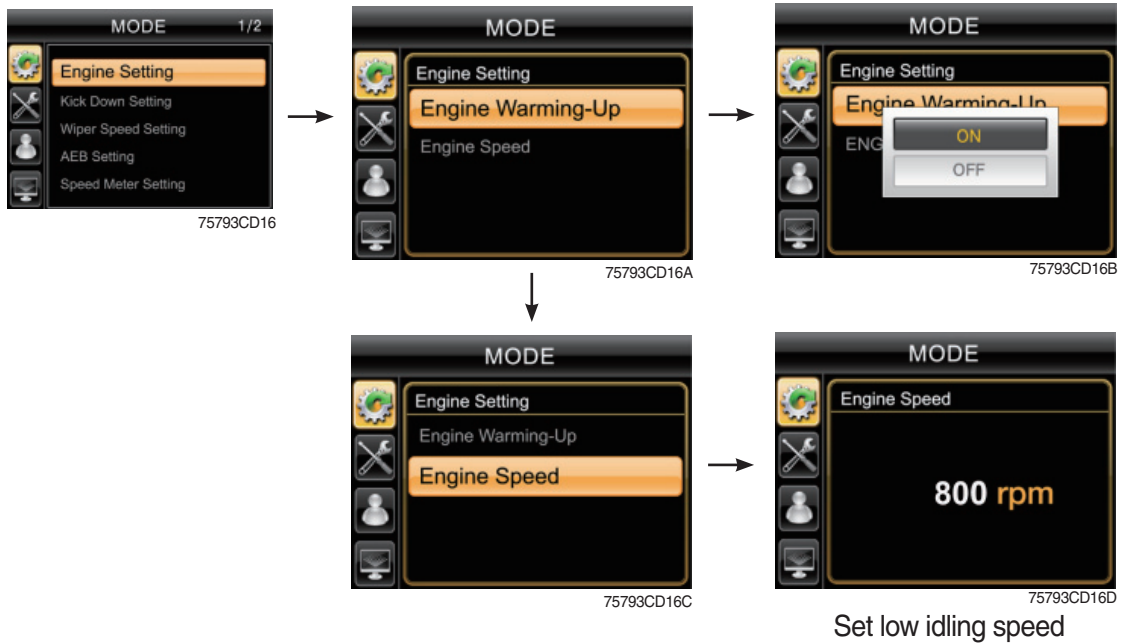

② Kick down setting

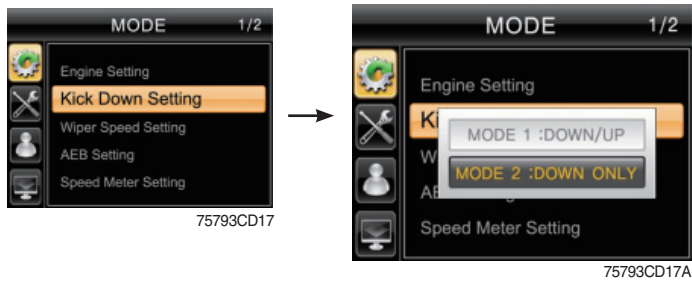

- Mode 1 (down/up) : Press kick down button once, shift down and press button again, shift up.
- Mode 2 (down only) : Press kick down button every time, shift to lower gear respectively.

※ Refer to page 3-31.

③ Wiper speed setting



- Setting wipe speed 1 to 4.

④ Fan-auto mode



- Select reverse interval or reverse time.
- Set reverse interval (30~300 min) or reverse time (30~300 sec).
- ※ Default : Interval (60 min), time (120 sec)
- ※ Refer to page 3-27, fan control switch.

⑤ AEB setting



- AEB mode controls the disk clearance of the transmission, automatically.
- To start AEB setting, press **⏸** and hold for 3 seconds.
- To cancel AEB setting, press **MENU**, **ESC** or **⏸**.
- If "OK" in actual gear window, press **MENU**, **ESC** or **⏸** to complete AEB setting.
- **Display during AEB mode**

| Symbol | Meaning |
|-----------------|-------------------------------------------------------------------|
| ST | Start AEB |
| K1~K4, KV, KR | Calibrating clutch K1~K4, KV or KR respectively |
| OK* | Calibration for all clutches finished |
| Spanner and Kx* | Kx couldn't be calibrated, AEB finished |
| △E | Engine speed too low - Raise engine speed |
| ▽E | Engine speed too high - Lower engine speed |
| △T | Transmission oil temperature too low - Heat up transmission |
| ▽T | Transmission oil temperature too high - Cool down transmission |
| FO* | Output speed not zero |
| FN* | Shift lever not in neutral position |
| FP* | Parking brake not applied |

* : Transmission stays in neutral, you have to restart the TCU (ignition off/on).

⑥ Speed meter setting



- Press and hold for 3 seconds.
- To change the pulse value, press or .
- To change the position, press .
- ※ Only for the serviceperson.

⑦ Sensor calibration

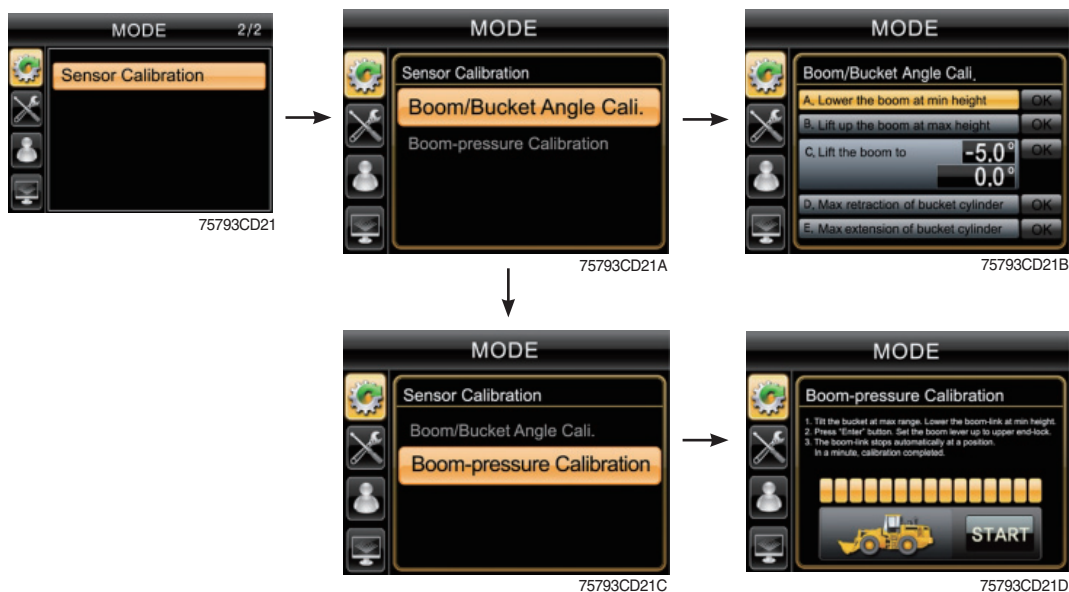

- **Boom / Bucket angle calibration**
 - The angle sensors can be calibrated by this menu.
 - Follow the each instruction and press .
 - If all step is completed, shows "Calibration Complete" message. Then, press .
- **Boom pressure calibration**
 - Follow the each instruction and press .
 - If it show "Succeed" message in a moment, press .

(3) Monitoring

① Fault code

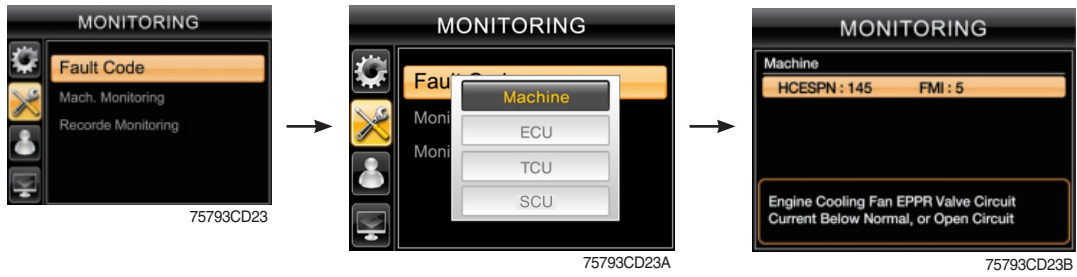

- Monitor the fault code of the Machine/ECU/TCU/SCU.
- ※ Not define will be indicated in case of that there's no fault.

② Machine monitoring

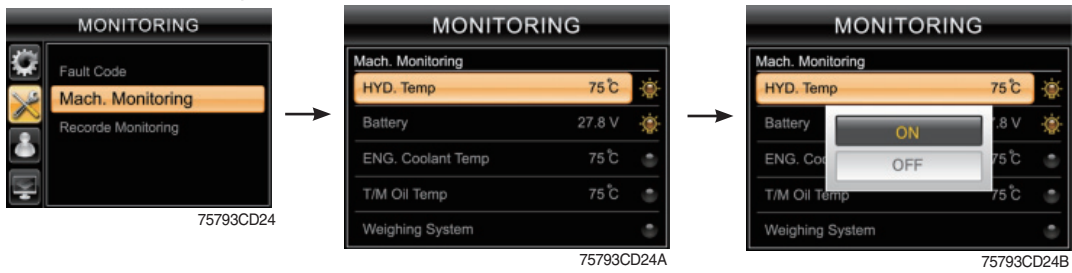

- Monitor the status of the machine.
- To check the item in main display, choose it and press .
- The right icon shows ON/OFF status.

※ Priority in the main display



The example of the weighing system

- The priority of the weighing system is the highest.
- If selected the weighing system, the other items are not available.
- To check the other items, the weighing system should not be selected.

③ Record monitoring

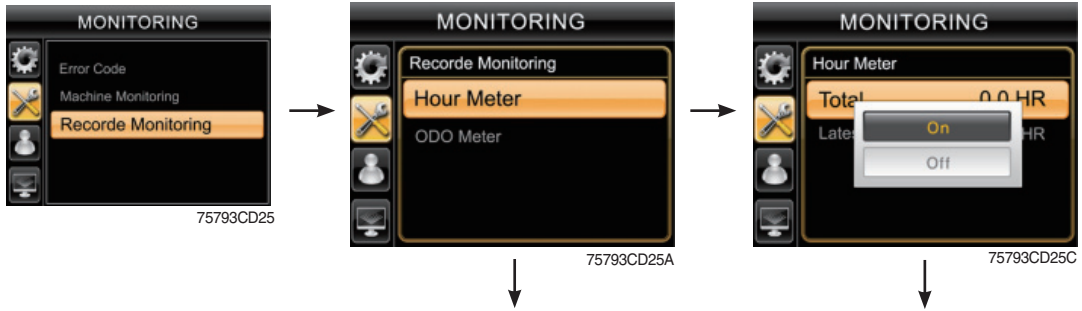

· Hour meter

- **Total** : total hour meter

To show the item in the main display, select "ON" and press (this item could not reset).

- **Latest** : the latest hour meter after reset.

To show the item in the main display, select "ON" and press .

To reset the latest hour meter, select "initializing" and press .



· ODO meter

- **Total** : total hour meter

To show the item in the main display, select "ON" and press (this item could not reset).

- **Latest** : the latest hour meter after reset.

To show the item in the main display, select "ON" and press .

To reset the latest odometer, select "initializing" and press .



(4) Management

① Machine security



· ESL system setting

- ESL : Engine Starting Limit
- ESL mode is designed to be a theft deterrent or will prevent the unauthorized operation of the machine.
- If the ESL mode was selected Enable, the password will be required when the start switch is turned ON.
- Disable : Not used ESL function
- Enable : The password is required whenever the operator start engine.

Interval mode : The password is required when the operator start engine first. But the operator can restart the engine within the interval time without inputting the password.
The interval time can be set maximum 2 days.

※ **Default password : 00000 ***

· Interval setting

- If set interval setting to 5 minutes, ESL system is activated after 5 minutes.
- Therefore, the password does not need to restart engine within 5 minutes.

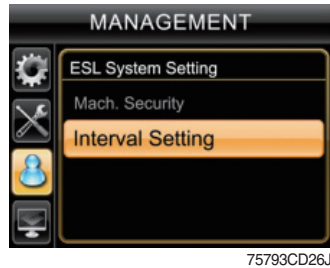

- **Change passage**
 - Input 5 to 10 digits and press *.

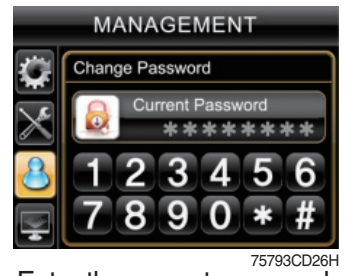

Enter the current password.



Enter the new password.



The new password is stored in the MCU.



Enter the new password again.

② Maintenance

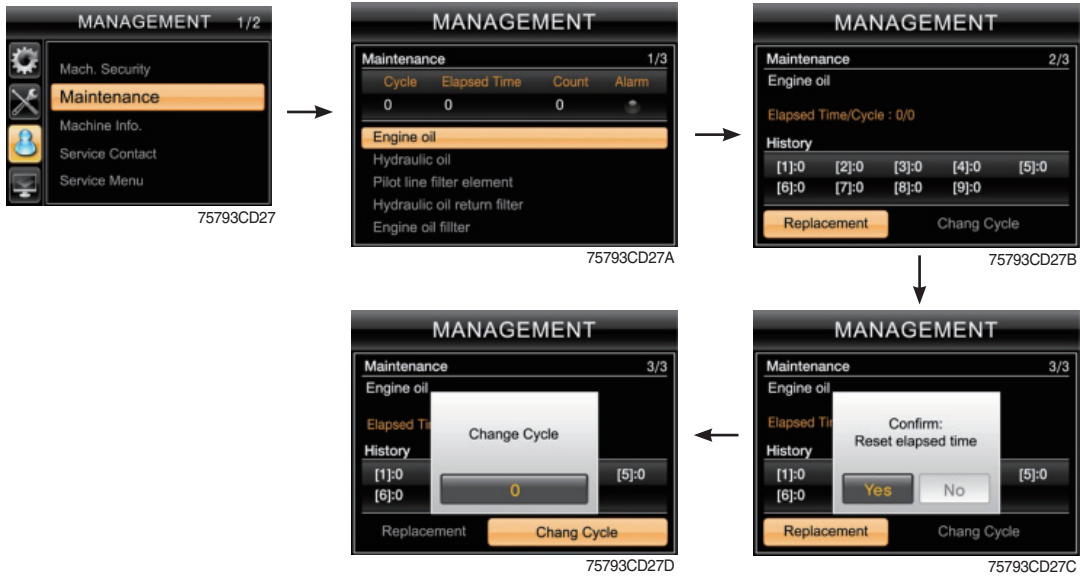

- Alarm (⚠) : Warning
 Replacement : The elapsed time will be reset to zero.
 Change cycle : The change or replace cycle can be changed in the unit of 50 hours.
- To change cycle, press ◀ or ▶/⏹.
- **Change or replace interval**

| No | Item | Interval |
|----|-----------------------------|--------------------------------------------|
| 1 | Engine oil | 500 |
| 2 | Hydraulic oil | ★ ¹ 2000 ★ ² 5000 |
| 3 | Pilot line filter element | 1000 |
| 4 | Hydraulic oil return filter | 1000 |
| 5 | Engine oil filter | 500 |
| 6 | Fuel filter element | 500 |
| 7 | Fuel pre-filter | 500 |
| 8 | Hydraulic tank air breather | 250 |
| 9 | Radiator coolant | 2000 |
| 10 | Transmission oil and filter | 1000 |
| 11 | Axle oil (front and rear) | 1000 |

★¹ : Conventional hydraulic oil

★² : Hyundai genuine long life hydraulic oil

③ Machine information

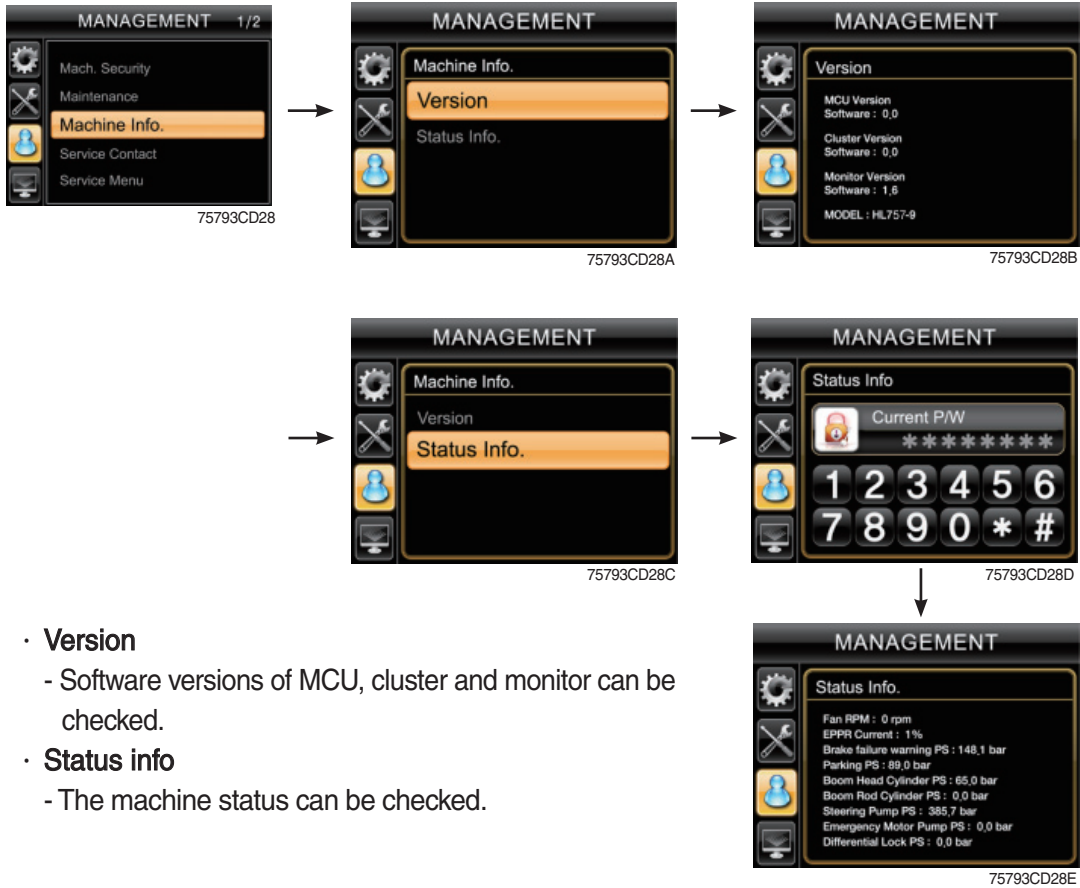

④ Service contact

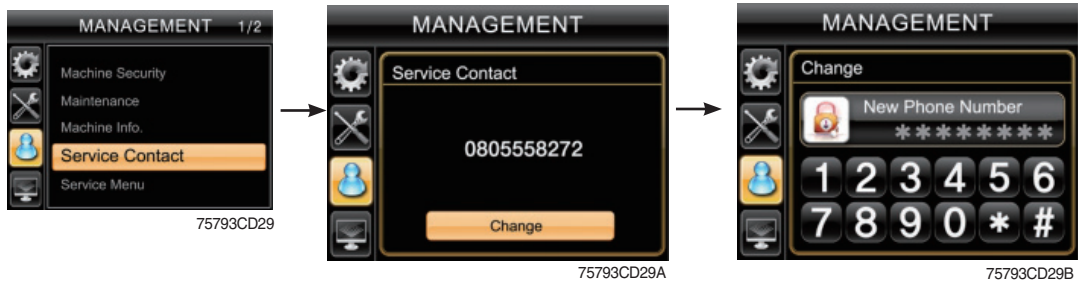

⑤ Service menu



(5) DISPLAY SET UP

① Clock

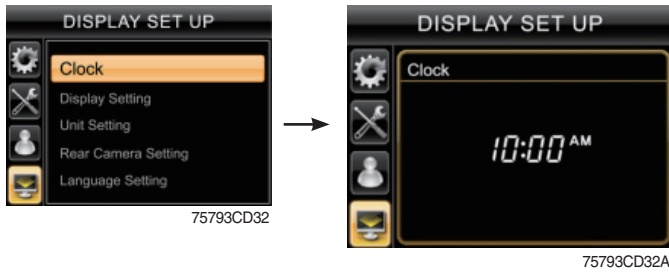

- To set time, press ◀ or ▶/⌘.
- To move position, press ⌚.

② Display setting

· Brightness setting

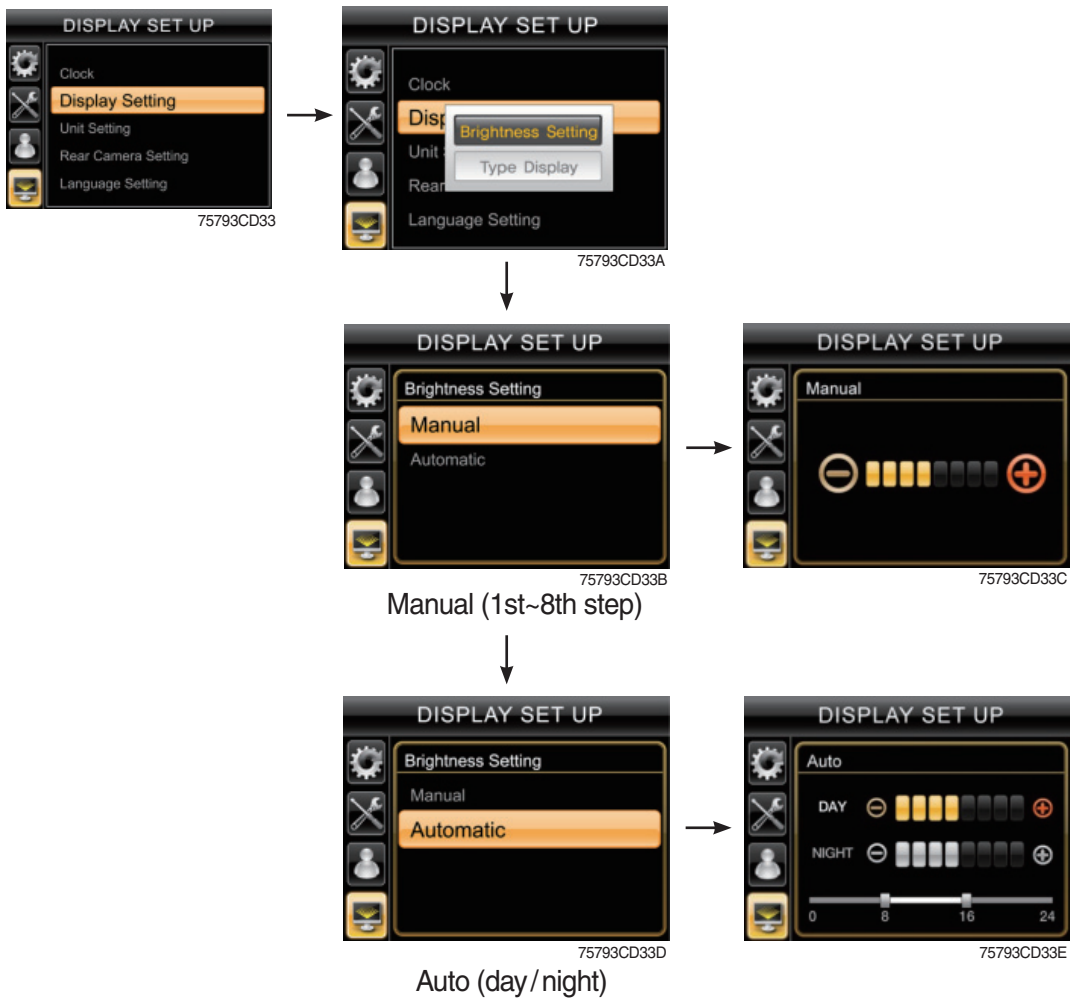

- ※ If "Automatic" is chosen, brightness for day and night can be differently set up. Also by using the bar in lower side, users can define which time interval belongs to day and night. (in bar figure, gray area represents night time while white shows day time)

· Display type setting



A type



B type

③ Unit setting

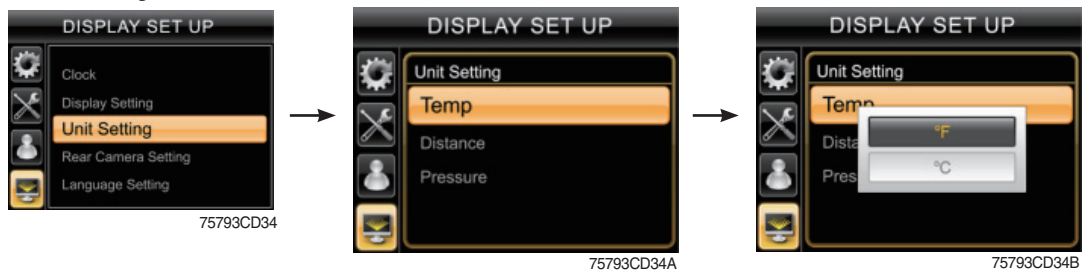

- Temperature : °C ↔ °F
- Distance : km ↔ mile
- Pressure : bar ↔ Mpa ↔ kgf/m² ↔ psi

④ Rear camera setting



- **Reverse mode**
 - If transmission engages the reverse gear (R1~R3), the camera mode is displayed automatically in main display.
- **Active camera**
 - Three cameras can be installed on the machine.
 - The display order can be set by this menu.
 - If the camera was not equipped, this menu is not useful.
 - In main display, if the **ESC** button is pushed, the first ordered display camera will be viewed.

⑤ Language setting



- User can select preferable language and all display are changed the selected language.