

5. MAINTENANCE CHART

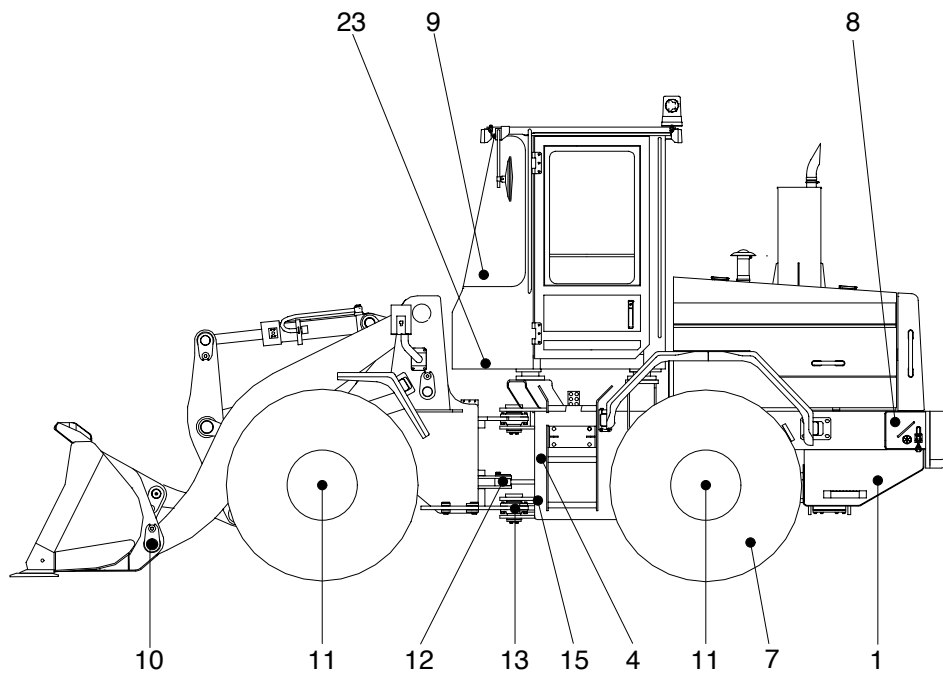
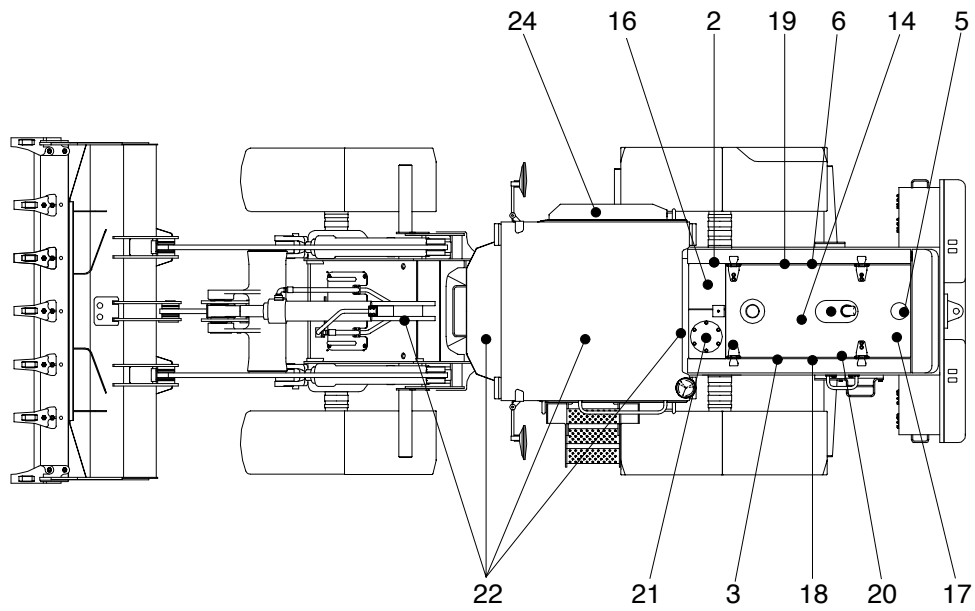

7203CM101

Caution

1. Service intervals are based on the hour meter reading.
2. The number of each item shows the lubrication point on the machine.
3. Stop engine while filling oil, and use no open flames.
4. For other details, refer to the service manual.

Service interval	Item No.	Description	Service action	Oil symbol	Capacity (U.S. gal)	Service points No.
10 Hours or daily	1	Fuel level(Fuel tank)	Check, Refill	DF	150(39.6)	1
	2	Hydraulic oil level	Check, Add	HO	45(11.9)	1
	3	Engine oil level	Check, Add	EO	11(2.9)	1
	4	Transmission oil level	Check, Add	EO	17(4.5)	1
	5	Radiator coolant level	Check, Add	C	30(7.9)	1
	6	Air cleaner element	Check, Clean			1
	7	Tire(Air)	Check, Add			4
	8	Battery(Electrolyte)	Check, Add			2
	9	Warning lamps	Check, Clean			1
50 Hours or weekly	10	Attachment pins	Check, Refill	PGL		13
	22	Drive shafts	Lubricate	PGL		8
	24	Air conditioner and heater outer filter	Check, Clean			1
100 Hours	11	Axle oil level	Check, Add	GO	10.5(2.8)	6
	12	Steering cylinder pins	Lubricate	PGL		4
	13	Center pivot pin	Lubricate	PGL		2
	14	Rear axle pivot pin	Lubricate	PGL		2
250 Hours	1	Fuel tank(Water, sediment)	Drain	DF	150(39.6)	1
	6	Air cleaner element	Replace			1
	16	Hydraulic air breather element	Replace			1
	19	Pilot line filter	Replace			1
	21	Hydraulic return oil filter	Replace			1
	23	Brake line filter	Check, Clean			1
500 Hours	3	Engine oil	Change	EO	11(2.9)	1
	17	Fan belt tension	Check, Clean			1
	20	Engine oil filter	Replace			1
1000 Hours	4	Transmission oil	Change	EO	17(4.5)	1
	11	Axle oil	Change	GO	10.5(2.8)	6
	15	Transmission oil filter	Replace			1
	18	Fuel filter element	Replace			1
	24	Air conditioner and heater outer filter	Replace			1
2000 Hours	2	Hydraulic oil	Change	HO	45(11.9)	1
	5	Radiator coolant	Change	C	30(7.9)	1

Oil symbol

Refer the recommended lubricants for specification.

- EO : Engine oil
- HO : Hydraulic oil
- DF : Diesel fuel
- GO : Gear oil
- PGL : Grease
- C : Coolant