

5. AIR CONDITIONER AND HEATER

Air conditioner and heater are equipped for pleasant operation against outside temperature.

• Location of air outlet

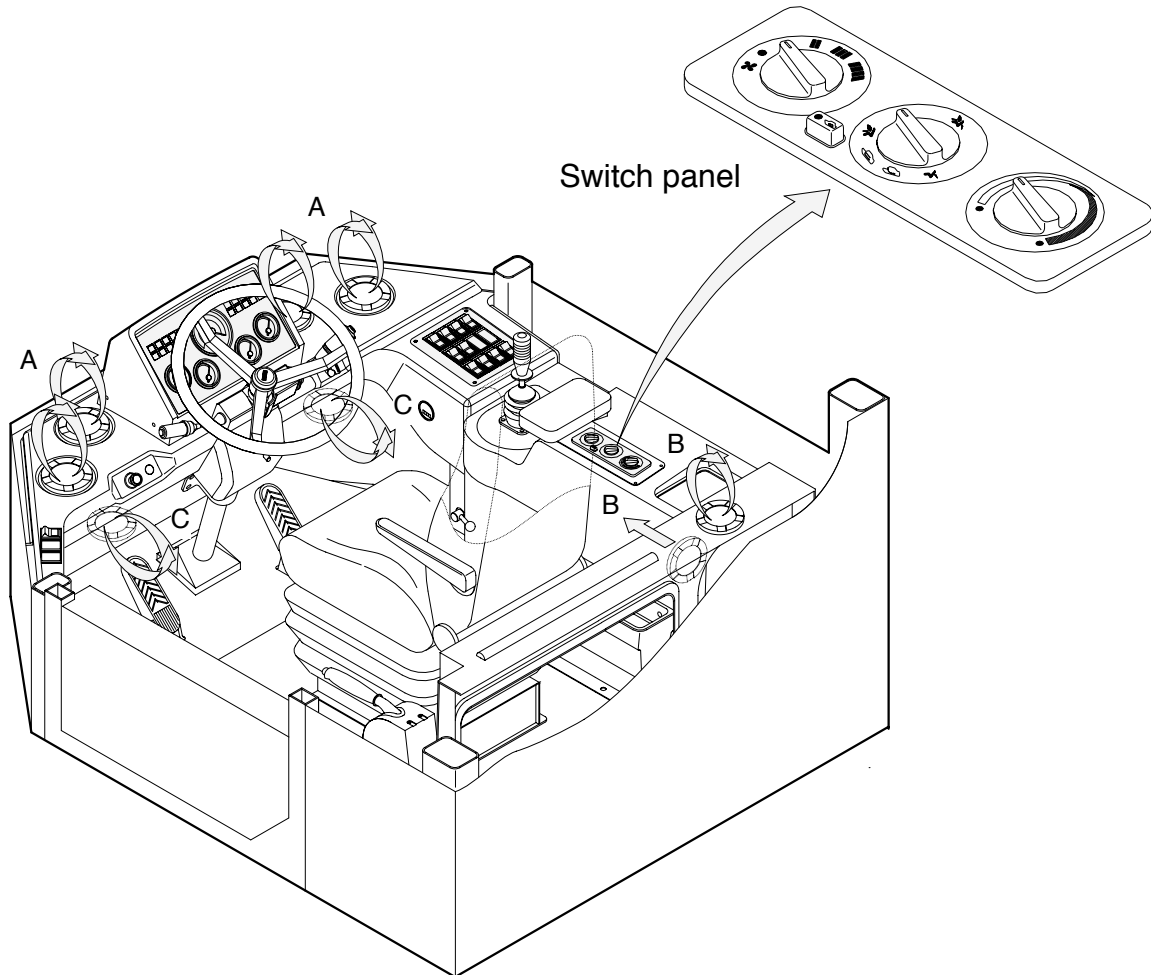

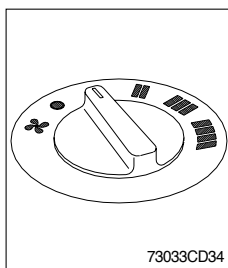

7203CCD04

1) FAN SWITCH



73033CD34

It is possible to control the fan to four steps.

-  : Low
-  : Medium-Low
-  : Medium-High
-  : High

2) OUTLET CHANGE OVER SWITCH

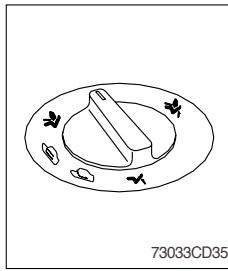

Switch position				
Outlet	A			
	B			
	C			

3) INLET CHANGE OVER SWITCH

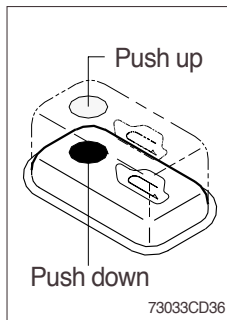

(1) Push down

The air circulates in the cab.
Indicator lamp.

ON	ON

(2) Push up

Fresh air intake.
Indicator lamp.

OFF	ON

4) TEMPERATURE CONTROL SWITCH

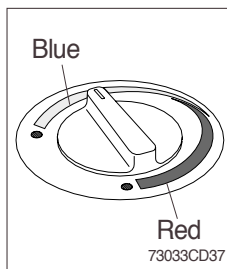

(1) Cooling(Air conditioner switch : ON)

Turned ON the air conditioner switch on the switch panel.
Turn the control switch into blue range to decrease output air temperature.

(2) Heating(Air conditioner switch : OFF)

Turned OFF the air conditioner switch on the switch panel.
Turn the control switch into red range to increase temperature.

5) OUTLET CONTROL LOUVER

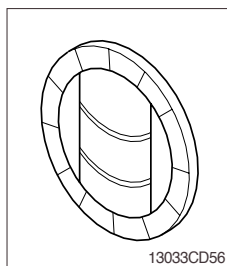

(1) The direction of air can be controlled.

(2) It can be closed or opened.