

5. MAINTENANCE CHART

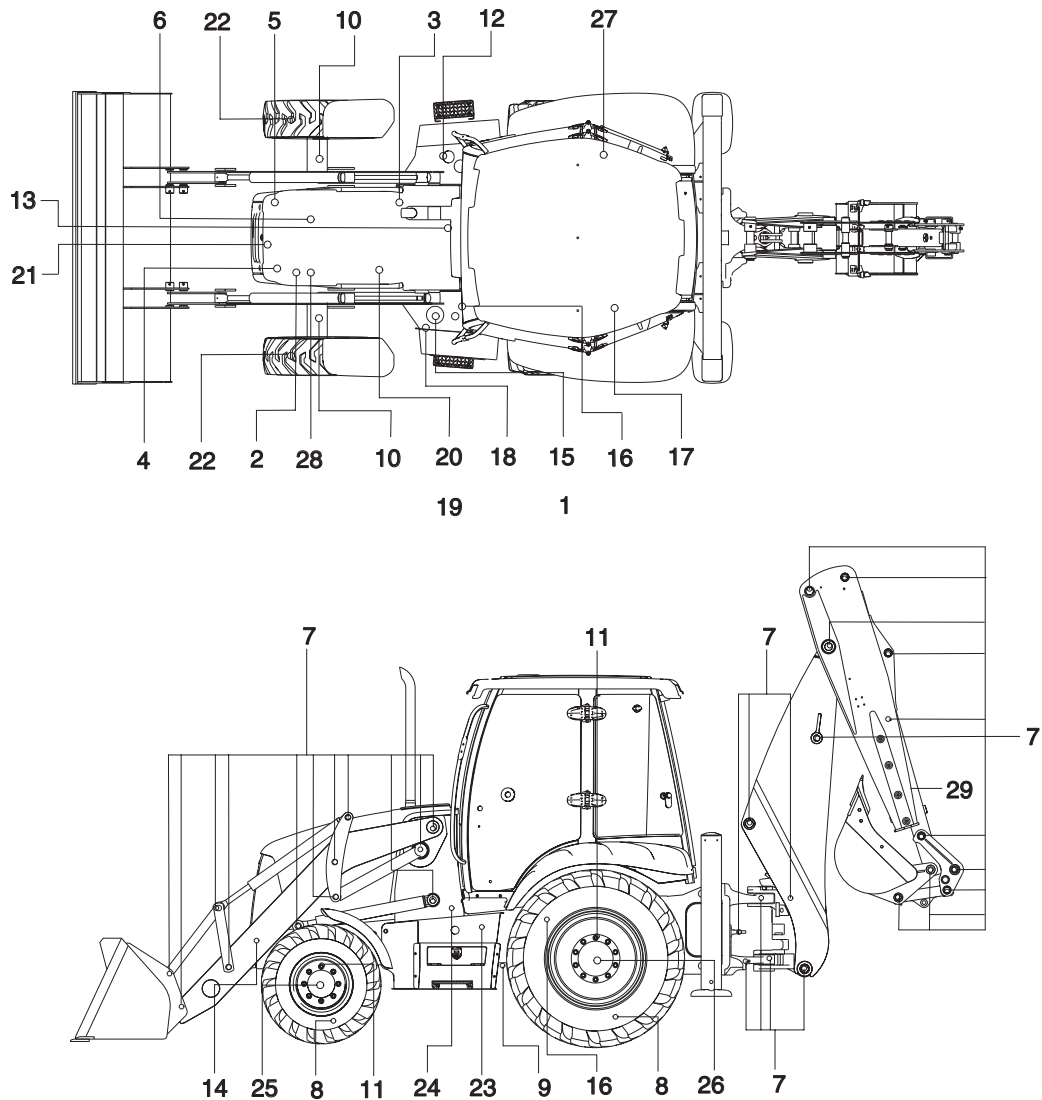

HB1006MC01

Caution

1. Service intervals are based on the hour meter reading.
2. The service intervals in this sign cannot be fit for rough work condition.
3. Be sure of engine stop when refilling.
4. Do not open the cap or drain plug while hot temperature of fluid to prevent unexpected spouting.
5. Open the cap slowly to relieve pressure.
6. Always keep the surfaces of control & instrument panels clean.
In case of damage or malfunction detected in panels, replace it by a new one.
7. Read "Maintenance check list" for details.

Service interval	No.	Description	Service action	Oil symbol	Capacity l (U.S.gal)	Service points No.
10 Hours or daily	2	Engine oil	Check, Add	EO	12 (3.2)	1
	4	Radiator coolant	Check, Add	C	19 (5.0)	1
	5	Belt tension and damage	Check	-	-	2
	13	Brake oil	Check, Add	BO	-	1
	21	Radiator, oil cooler, charge air cooler	Check, Clean	C	-	1
50 Hours or weekly	7	Attachment pins	Lubricate	-	-	44
	8	Tires (air)	Check	-	-	4
	11	Wheel nuts	Check, tighten	-	-	2
	20	Fuel prefilter (water separator)	Clean	-	-	1
	22	Front axle U-joint	Check, Lubricate	PGL	-	2
	29	Extending dipper	Check, Lubricate	PGL* ³	-	1
250 Hours	9	Drive shaft (spline)	Lubricate	PGL	-	1
	12	Fuel tank (water, sediment)	Check, Drain	-	-	1
	14	Battery (voltage)	Check	-	-	1
	15	Hydraulic oil return filter	Replace	-	-	1
	16	Hydraulic tank air breather element	Replace	-	-	1
	27	Cab fresh air filter	Clean	-	-	1
	28	Air cleaner element (primary)	Clean	-	-	1
500 Hours	9	Drive shaft (U-joint)	Lubricate	PGL	-	4
	10	Front axle pivot	Lubricate	PGL	-	1
	21	Radiator, oil cooler, charge air cooler	Clean	-	-	1
600 Hours	2	Engine oil	Change	EO	12 (3.2)	1
	3	Engine oil filter	Replace	-	-	1
	19	Fuel filter element	Replace	-	-	1
	20	Fuel prefilter element	Replace	-	-	1
1000 Hours	17	Pilot line filter element	Replace	-	-	1
	23	Transmission oil	Change	EO	18 (4.6)	1
	24	Transmission oil filter	Replace	-	-	1
	27	Cab fresh air filter	Replace	-	-	1
1500 Hours	25	Front axle oil	Change	UO	8 (2.1)	1
	26	Rear axle oil	Change	UO	16 (4.2)	1
2000 Hours	1	Hydraulic oil * ¹	Change	HO	60 (15.9)	1
	4	Radiator coolant	Change	C	19 (5.0)	1
	5	Belt tension and damage	Replace	-	-	2
	6	Engine valve clearance	Check, Adjust	-	-	4
	13	Brake oil	Change	BO	0.4 (0.1)	1
	18	Suction strainer	Check, clean	-	-	1
	27	Air conditioner and heater Inner filter	Replace	-	-	1
5000 Hours	1	Hydraulic oil * ²	Change	HO	60 (15.9)	1
As required	9	Drive shaft (spline)	Lubricate	PGL	-	1
	9	Drive shaft (U-joint)	Lubricate	PGL	-	4
	10	Front axle pivot	Lubricate	PGL	-	1
	13	Brake oil	Check, Add	-	-	1
	21	Radiator, oil cooler, charge air cooler	Check, Clean	-	-	1
	23	Transmission oil	Check, Add	EO	18 (4.6)	1
	27	Cab fresh air filter	Clean, Replace	-	-	1
	27	Air conditioner and heater Inner filter	Replace	-	-	1
	28	Air cleaner element (safety)	Replace	-	-	1
28	Air cleaner element (primary)	Replace	-	-	1	

*¹ Conventional hydraulic oil

*² Hyundai genuine long life hydraulic oil

*³ Shell Retinax HDX2

※ Oil symbol

Please refer to the recommended lubricants for specification.

EO : Engine oil

PGL : Grease

HO : Hydraulic oil

UO : UTTO

BO : Brake oil, mineral

C : Coolant