

## 5. OPERATING LEVERS

### 1) LOADER CONTROLS

※ Confirm the operation of control lever and working device.

- (1) Control lever operates the boom and the bucket.
- (2) When you release the control lever, control lever returns to neutral position automatically.
- (3) When the control lever operates to the position of boom float, boom raise and bucket roll back ; these function is completed, then the control lever returns to the neutral position.

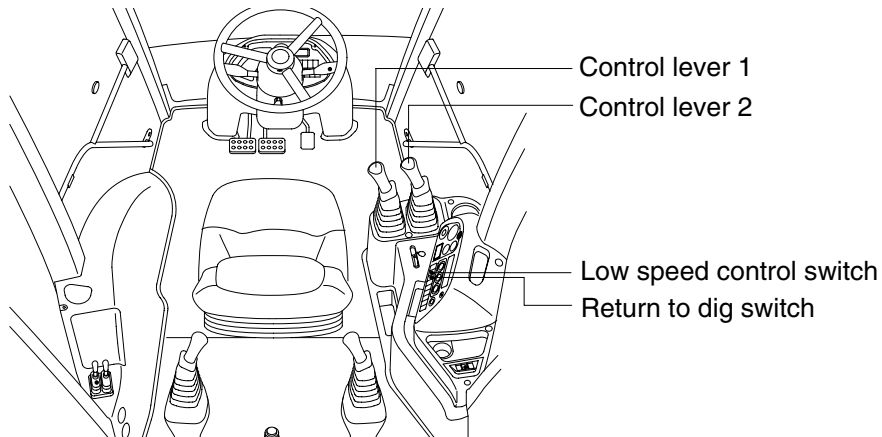

HB1004OP64

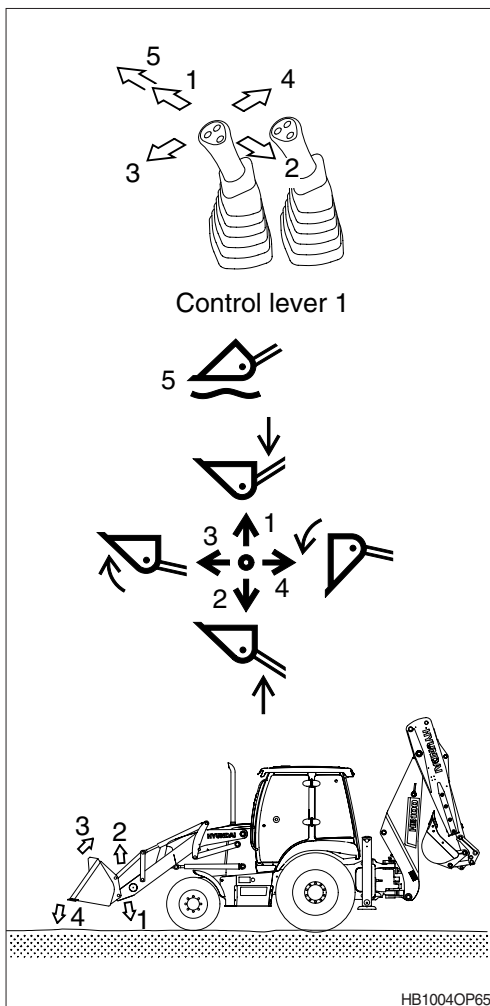

HB1004OP65

#### (4) Control lever 1

##### Boom lower (1)



Push the control lever forward in order to lower the boom.

##### Boom raise (2)



Pull the control lever backward in order to raise the boom.

##### Bucket roll back (3)



Move the control lever toward the left in order to tilt the bucket backward.

##### Bucket dump (4)



Move the control lever toward the right in order to dump a load from the bucket.

##### Boom float (5)



Push the control lever forward into the detent.  
The boom will lower to the ground.  
The boom will float along the contour of the ground.

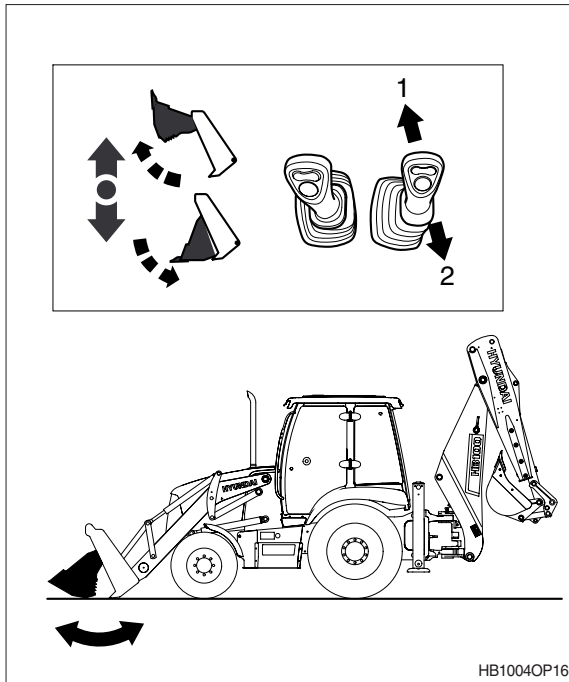

**(5) 6 in 1 clam shovel (if fitted)**

On machines fitted with a 6 in 1 clam shovel.

The second lever operates the clam on the 6 in 1 clam shovel.

The two levers can be operated at the same time to produce combined loader actions.

**Open clam (1)**

Push the control lever forward, in order to open the clam.

**Close clam (2)**

Pull the control lever back, in order to close the clam.

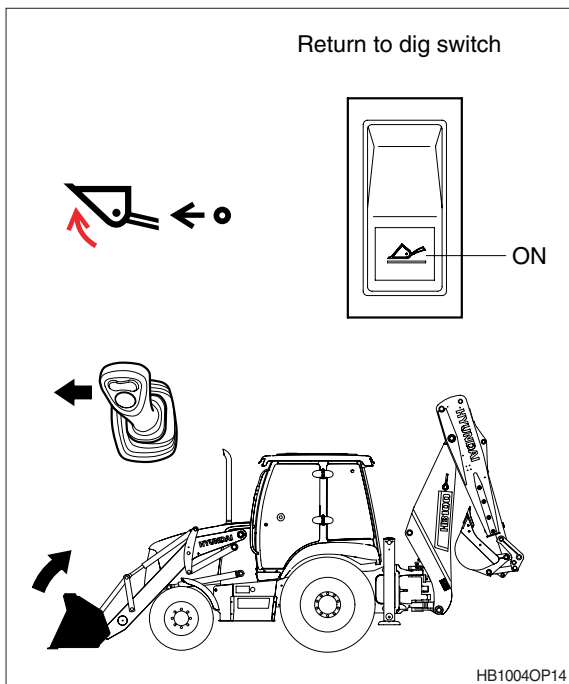

**(6) Return to dig**

This enables you to roll back the shovel from the dump position into the digging position quickly and easily.

To select return to dig.

Pull the lever to the left as far as it will go. You will feel a slight pressure on the lever as it passes through the roll back position. Release the lever, it will stay in the detent position until the shovel reaches the return to dig position when the lever will automatically return to the central hold position.

When return to dig is no longer required, press the switch to the OFF position.

## 2) BACKHOE CONTROLS

※ Confirm the operation of control lever and working device.

(1) Left control lever controls dipper and boom swing.

(2) Right control lever controls boom and bucket.

(3) When you release the control lever, control lever returns to neutral position automatically.

### (4) ISO type (+) pattern : standard

When the control pattern change switch is selected position ①. (if equipped). Refer to the page 3-11.

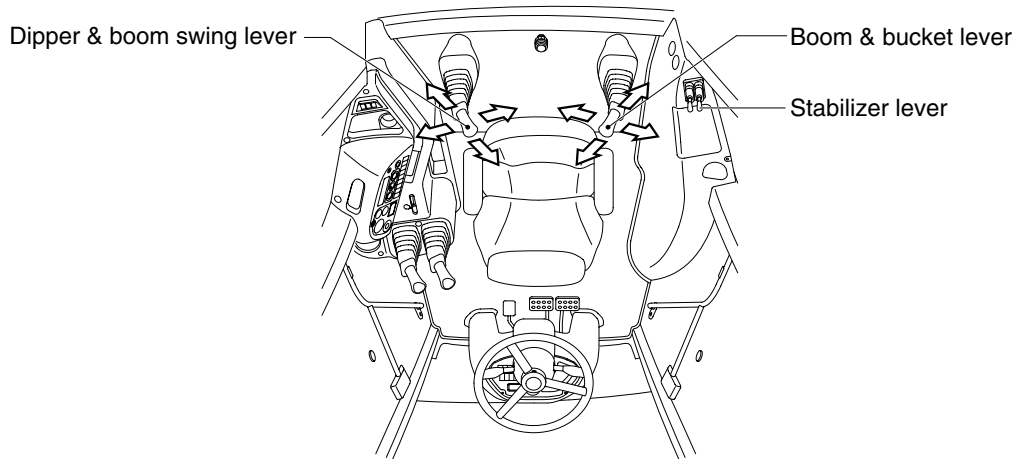

HB1004OP73

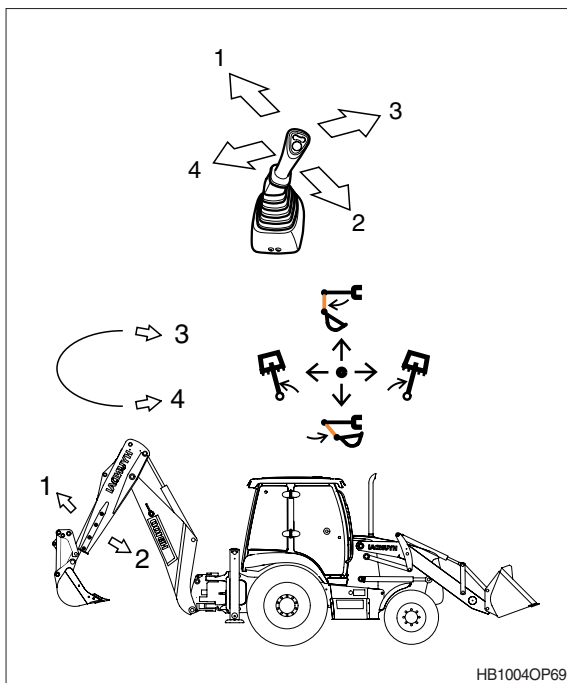

HB1004OP69

### ① Dipper & boom swing lever

- 1 Dipper roll-out
- 2 Dipper roll-in
- 3 Boom swing right
- 4 Boom swing left

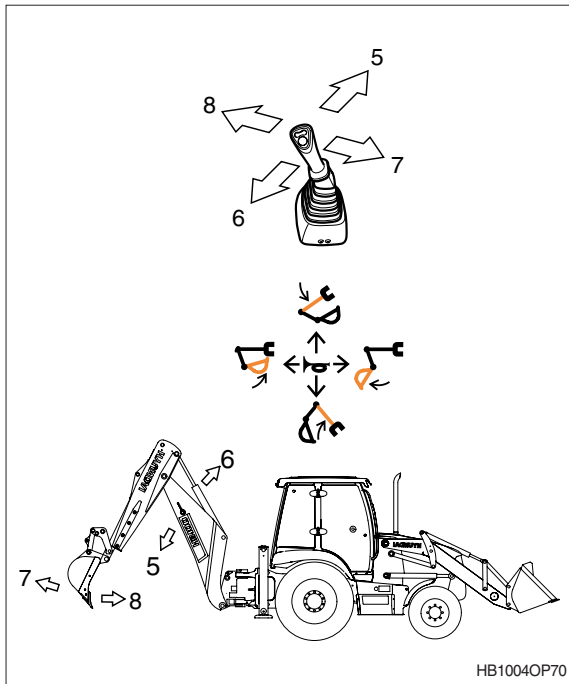

② Boom & bucket lever

- 5 Boom lower
- 6 Boom raise
- 7 Bucket roll-out
- 8 Bucket roll-in

(5) Hyundai A type (+) pattern : optional

When the control pattern change switch is selected position ②. (if equipped). Refer to the page 3-11.

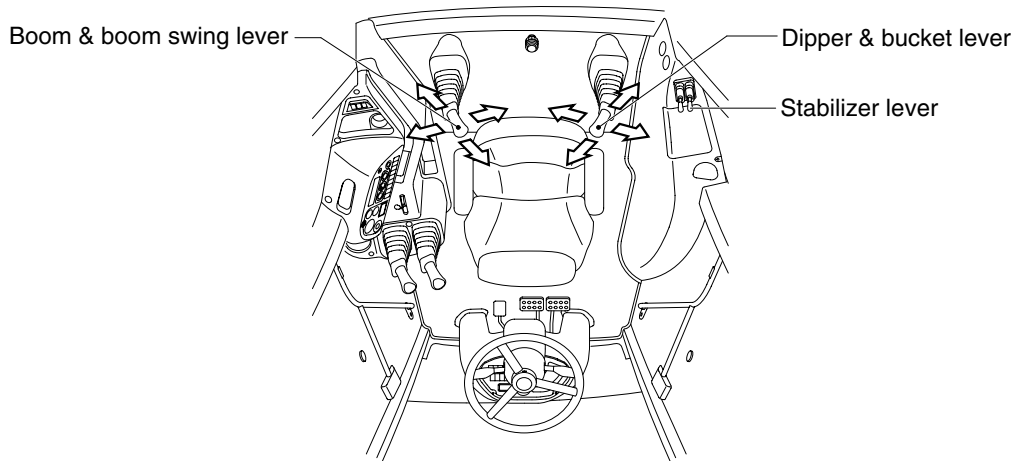

HB1004OP74

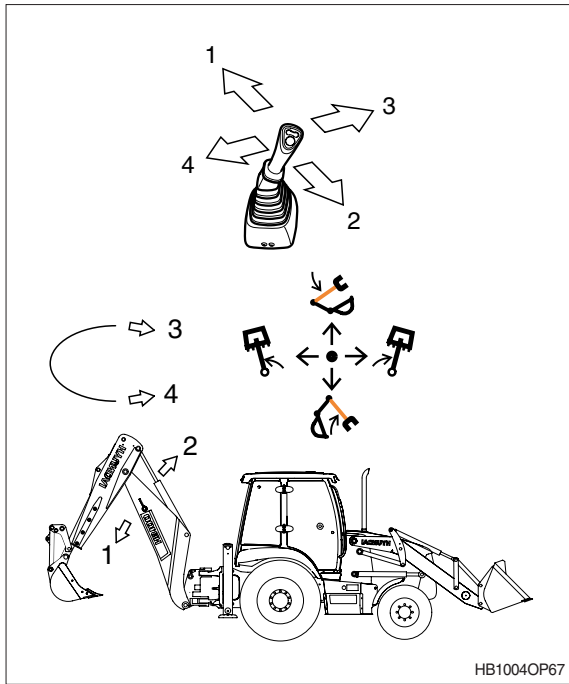

HB1004OP67

① Boom & boom swing lever

- 1 Boom lower
- 2 Boom raise
- 3 Boom swing right
- 4 Boom swing left

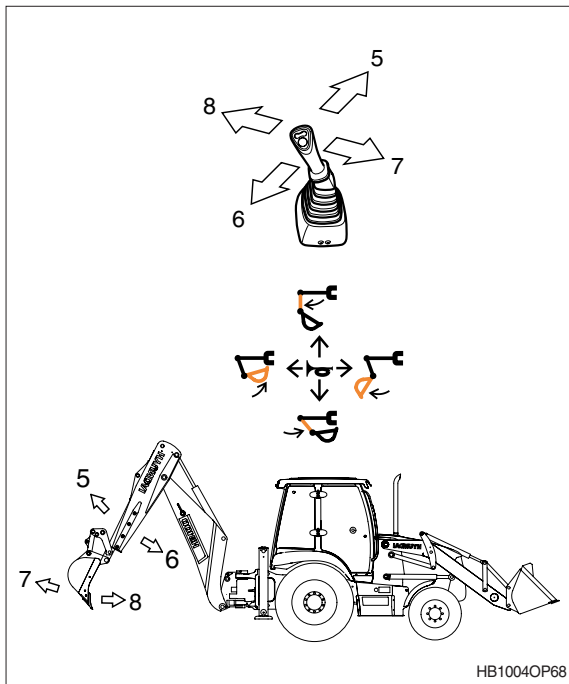

HB1004OP68

② Dipper & bucket lever

- 5 Dipper out
- 6 Dipper in
- 7 Bucket roll-out
- 8 Bucket roll-in

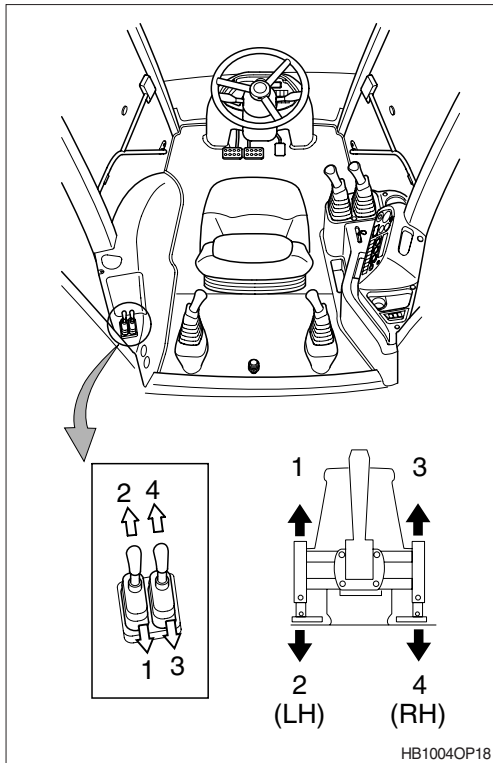

### 3) STABILIZER

#### (1) Lever controls

⚠ You must be sitting in the driving seat when operating the stabilizer controls.

Do not operate the stabilizers from outside the machine. Otherwise you could be crushed when the machine moves.

The stabilizers must be down when you use the excavator, or the machine will rock violently.

※ Each stabilizer has its own control lever and can be operated independently.

⚠ Lower each stabilizer to level the machine and take the weight off of the rear tires. The loader shovel should be used along with the stabilizers to level and steady the machine.

#### (2) Raise stabilizers (1, 3)

Push the levers towards the front of the operator, in order to raise the stabilizers.

#### (3) Lower stabilizers (2, 4)

Pull the levers towards the rear of the operator, in order to lower the stabilizers.

Occasionally there may be a need for fully extending one or both stabilizer legs and rams in order to level the machine on steep slopes.

In these conditions it may be necessary to use the boom to apply a down force to enable the stabilizer to fully extend. In these conditions raising the shovel off the ground also helps.

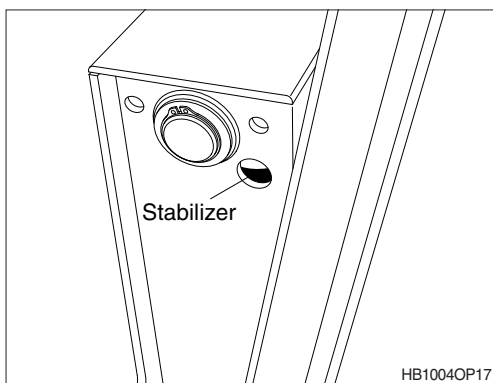
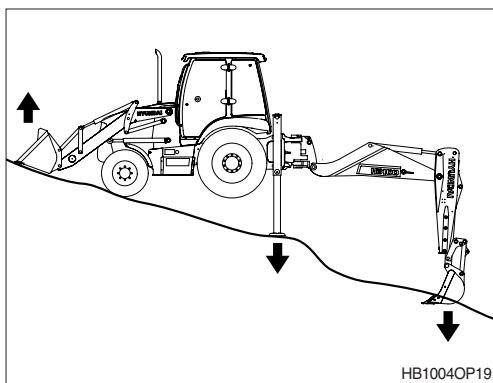

※ Before traveling, fully raise both stabilizer legs. When stabilizer leg has fully raised, the top of the stabilizer leg can be seen through the hole. If the stabilizer leg has not been fully raised the stabilizer leg will not be visible.