

3. CONTROL DEVICE

1. CAB DEVICE

1) The ergonomically designed console box and suspension type seat provide the operator with comfort.

2) ELECTRONIC MONITOR SYSTEM

(1) The centralized electronic monitor system allows the status and conditions of the machine to be monitored at a glance.

(2) It is equipped with a safety warning system for early detection of machine malfunction.

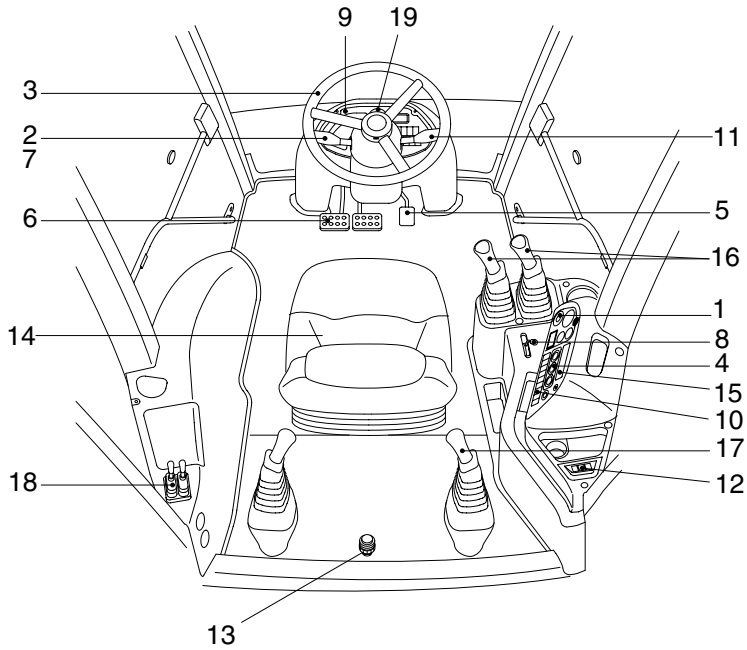

HB1003CD18

- | | |
|----------------------------|-----------------------------------|
| 1 Start switch | 11 Multi-function switch and horn |
| 2 Gear selector switch | 12 Rear console switch |
| 3 Steering wheel | 13 Boom lock |
| 4 Aircon and heater switch | 14 Seat |
| 5 Accelerator pedal | 15 Radio/USB player |
| 6 Brake pedal | 16 Loader controls |
| 7 FNR lever | 17 Backhoe controls |
| 8 Hand throttle lever | 18 Stabilizer controls |
| 9 Front console | 19 Speed meter |
| 10 Side console | |